

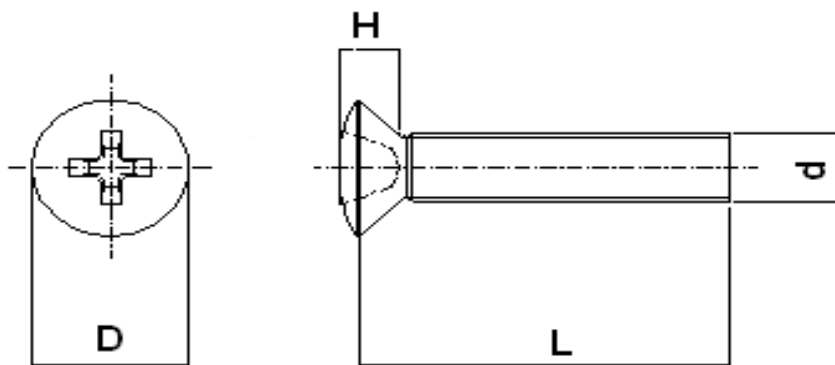

Part Name	PO/MS M6X30 PUTIH		P/O								OK
Part No.	BOLT JO 6X30		Test Date		4 Juli 2025						
Cust. P/N	PT. Chitose Mfg.		Qty		6000 pcs						
Material	SWCH 8A		Test Qty		5 Pcs						
Test Item	Instrument	Specification	Test Result								
			1	2	3	4	5	Max	Min	R	Result
•Dimension											
D	Micrometer	11,30 ~ 12,00	11,47	11,59	11,52	11,65	11,61	11,65	11,47	0,18	OK
H	Height Gauge	4,20 ~ 4,80	4,52	4,53	4,55	4,53	4,52	4,55	4,52	0,03	OK
L	D.Caliper	29,00 ~ 30,00	29,62	29,54	29,43	29,91	29,69	29,91	29,43	0,48	OK
d	Micrometer	5,79 ~ 5,97	5,90	5,91	5,90	5,91	5,90	5,91	5,90	0,01	OK
•Appearance											
Plating	Visual	• Putih	OK	OK	OK	OK	OK				OK
		• Tidak Berkarat	OK	OK	OK	OK	OK				OK
		• Tidak Kusam	OK	OK	OK	OK	OK				OK
Fisik	Visual	• Tidak Cacat	OK	OK	OK	OK	OK				OK
		• Tidak Burry	OK	OK	OK	OK	OK				OK

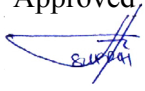

LOT NO.		Approved 	Inspection 
NO.WOE/Packing			



PT. MEGA PRATAMA FERINDO

PT. MEGA PRATAMA FERINDO

MATERIAL SAFETY DATA SHEET

Section 1. Product & Company Identification

Product Name : Cold Drawn Steel Wire
Company Identification: PT. Mega Pratama Ferindo
Address : Jl. Industri Raya III Blok AB No.5 Zona Industri Raya Jatake
Tangerang 15710, Indonesia
Phone : + 62 21 5901927 or + 62 21 5901928
Fax : + 62 21 5901929

Emergency Phone No: Same as the above

Section 2. Composition & Information on Ingredients

Distinction (single-component: substance, or compound): Compound (alloy)

Composition and content : refer to MILL SHEET

CAS No. And ICSC No.

Element	Content (mass %)	CAS No	ICSC No	Note
Iron (Fe)	99 or lower	7439-89-8	-	-
Manganese (Mn)	25 or lower	7439-96-5	0174	O
Chromium (Cr)	10 or lower	7440-47-3	0029	O
Nickel (Ni)	4 or lower	219/7440	0062	O

Note : O Mark indicates those that are regulated by industrial Safety and Health Law

Section 3. Summary of Hazards

This product is solid at room temperature and is chemically stable. However, it's fume or coarse particulate that occur during machining, such as welding, thermal cutting, grinding and machining, may irritate mucous membrane of respiratory organs, eye, etc. And arc or chips that are generated from machining may cause burns or cut wounds to human body

Section 4. First-Aid Measures

Appropriate protection should be provided against fume, dust, arc, chips that occur during the machining of welding, thermal cutting, cutting, grinding, Etc

- Inhalation : Remove to fresh air. Use breathing assistance
- Skin Contact : Wash thoroughly with soap and water
- Eye Contact : Flush with clean water sufficiently
- Ingestion : Vomit immediately. Take gargling
- Burns : Cool the affected part sufficiently, Apply medicine
- Cut wounds : Flush with clean water, Apply medicine

For all case above, see a physician if necessary

Section 5. Fire-Fighting Measures

Not applicable. The product is solid and chemically stable

Section 6. Accidental-Release Measures

Not applicable. The product is solid under normal conditions

Section 7. Handling and Storage

- Handling : Wear protective glove to prevent possible cut wounds due to sharp edges of product
Storage : If necessary, provide preventive measures against leakage of rainwater, seawater, etc
Also, ensure to keep the products from falling.





PT MEGA PRATAMA FERINDO

PT. MEGA PRATAMA FERINDO

MATERIAL SAFETY DATA SHEET

Section 8, Exposure Controls and Personal Protections

The Product is solid and chemically stable

However, during welding, thermal cutting, grinding, etc. Use respiratory protection mask, safety goggles, protective glove, and protective clothing to guard face, hand and foot against the fumes, dust chips, etc. Occurring from machining.

Section 9, Physical and Chemical Properties

Physical State : Solid showing silver-white under normal conditions

Physical Properties : - Melting point : 1440 - 1535 °C

- Specific Gravity : Approx, 7.85

Section 10, Stability and Reactivity

The product is chemically stable having Fe as its base and some alloy elements as additives so reactivity is low.

Section 11, Hazards Information

As a steel product, no significant data on toxicity for humans has been reported to date. For some alloy elements, however, potential hazards are pointed out. When each element as a single-component substance exceeds allowable concentration rate and the machining mentioned in section 9 are applied.

Section 12, Environmental Impact

As a steel product, no significant data on environment impact has been reported up to the present

Section 13, Disposal Consideration

Disposal of by using officially licensed waste disposal agent, if any deposit is involved, take due consideration for such deposit as well.

Section 14, Transport Information

Since it is heavy load, fasten tightly to avoid tumbling of load, it is advisable to provide measure against leak in of rain water.

Section 15, Applicable laws and regulations

Industrial Safety and Health Law (attention : This law is available in Indonesia)

Section 16, Other Information

Contact for inquiries about the contents of this data sheet :

Product Name : Rolled Steel

Company Identification : China Steel Corporation

Address : China Steel

Address : Chung Kang Road, Hsiao Kang, Kaohsiung 81258, Taiwan

Phone: 886 (7) 802-1111 Ext.3821

Fax : 886 (7) 805-1292

e-mail address : 072223 @mail. csc. com. tw

Emergency Phone No: Same as the Emergency P





PT MEGA PRATAMA FERINDO

PT. MEGA PRATAMA FERINDO

MATERIAL SAFETY DATA SHEET

The information in this MSDS was obtained from sources which we believe are reliable. This material Safety Data Sheet is made available to the product user as " references data " to help them ensure the worker's safety and prevent personal injuries it is not intended to guarantee the safety of product. The product may cause such potential hazards that are not our know ledge to date
It is the user's responsibility to implement the proper measures for their own particular situation.
making reference to the information provided in this Material Safety Data Sheet .

