

25986

13865

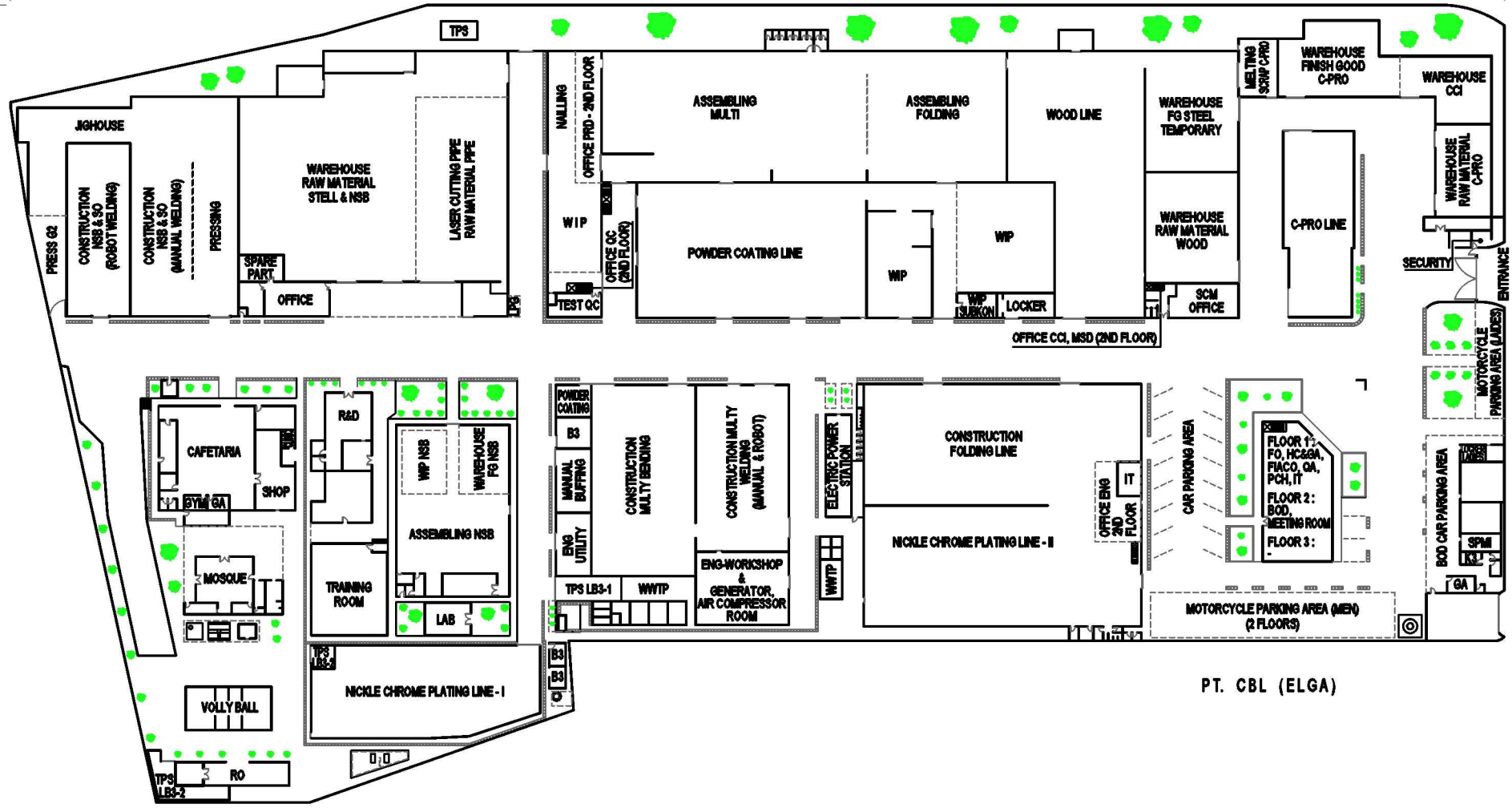

PT. CBL (ELGA)

	REVISI	TANGGAL EFEKTIF	NAMA, PARAF, TANGGAL			Gambar : L A Y O U T PT. CHITOSE INTERNASIONAL, TBK MANUFACTURING SYSTEM DEVELOPMENT PT Chitose Internasional Tbk
		03.12.2024	DIGAMBAR	DIPERIKSA	DISETUJUI	
			O. Tohya			
						Satuan : CM Skala : - Halaman : -

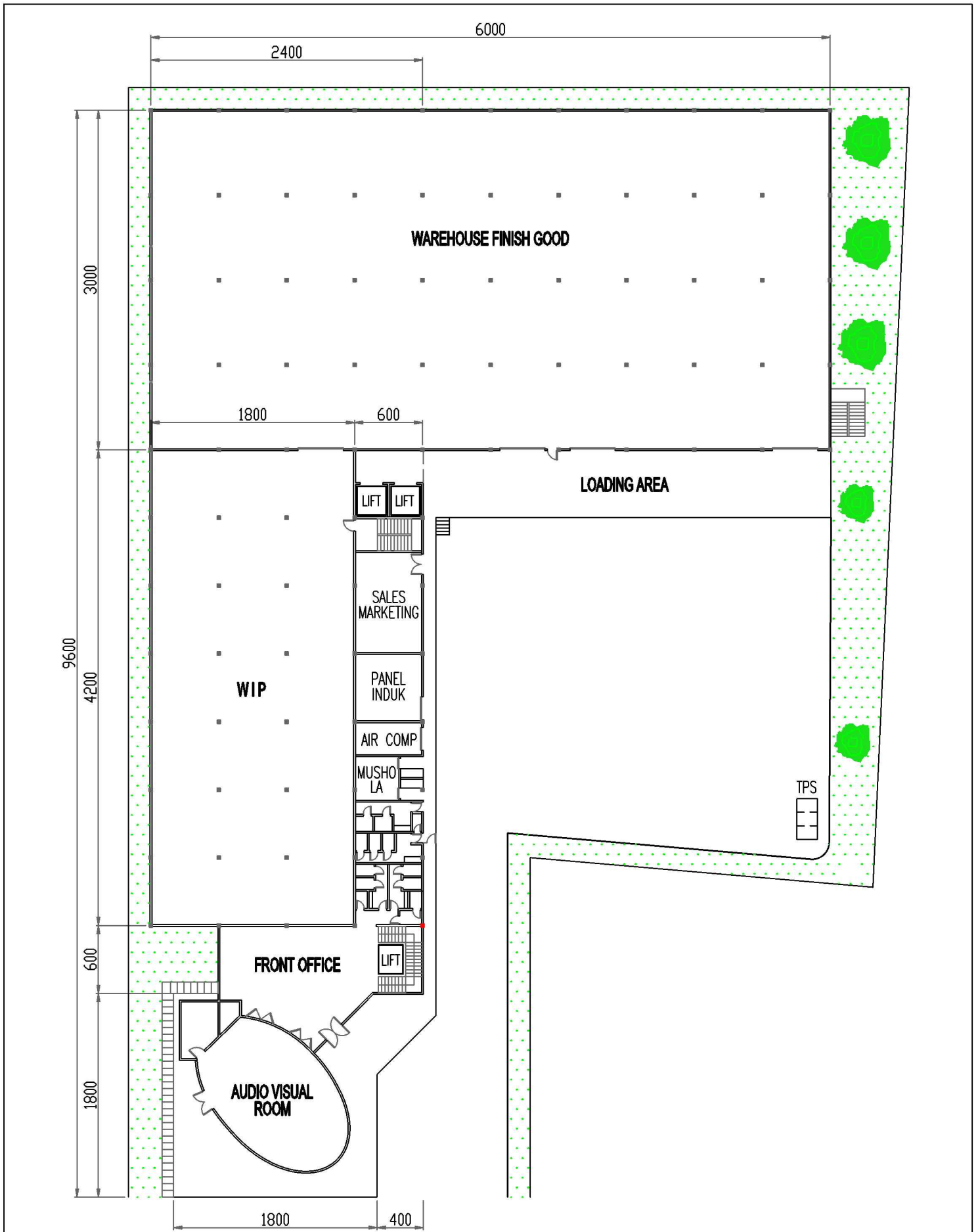

REVISI	TANGGAL EFEKTIF	NAMA, PARAF, TANGGAL			Gambar :
		DIGAMBAR	DIPERIKSA	DISETUJUI	
▲	06.01.2025	O. Tahya			LAYOUT DC BAROS GROUND FLOOR MANUFACTURING SYSTEM DEVELOPMENT PT Chitose Internasional Tbk
▲					
▲					

Satuan : CM
 Skala : -
 Halaman : 1

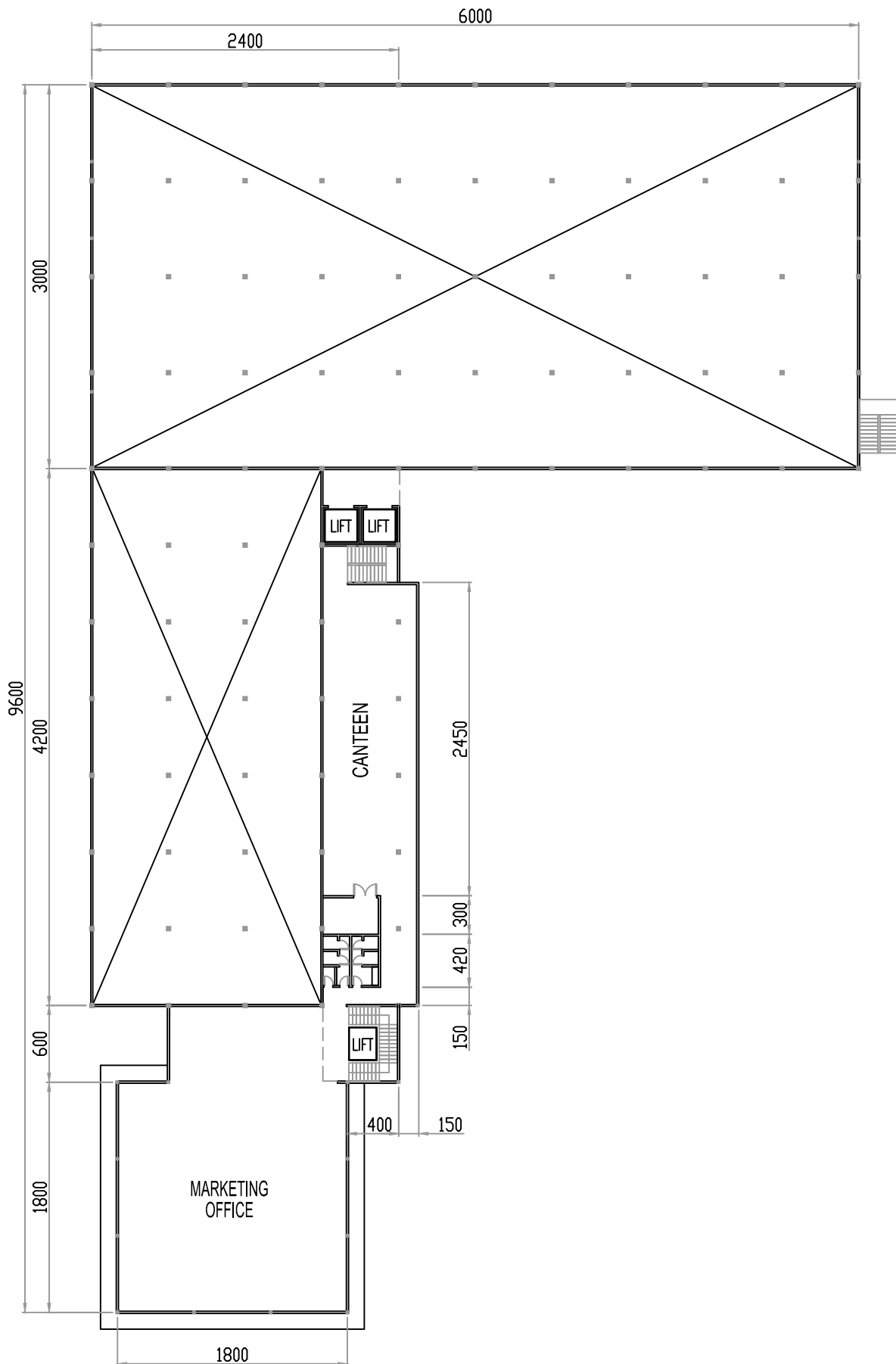

REVISI	TANGGAL EFEKTIF	NAMA, PARAF, TANGGAL		
		DIGAMBAR	DIPERIKSA	DISETUJUI
△	06.01.2025	O. Tahya	.	.
△				
△				

Gambar : **LAYOUT DC BAROS
FIRST FLOOR**

**MANUFACTURING SYSTEM DEVELOPMENT
PT Chitose Internasional Tbk**

Satuan : CM
Skala : -
Halaman : 2

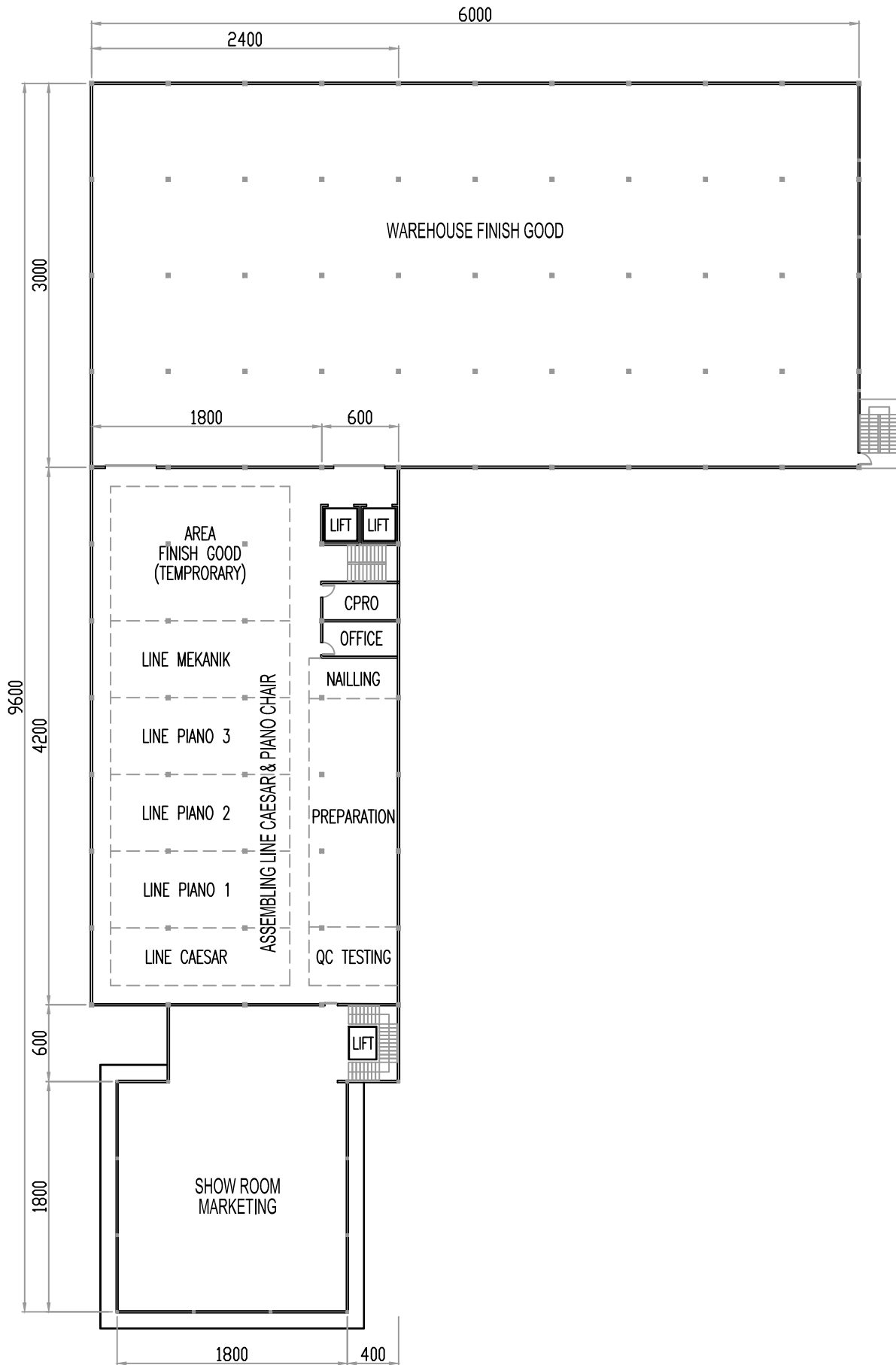

REVISI	TANGGAL EFEKTIF	NAMA, PARAF, TANGGAL				Gambar :
		DIGAMBAR	DIPERIKSA	DISETUJUI		
△	06.01.2025	O. Tahya				LAYOUT DC BAROS SECOND FLOOR MANUFACTURING SYSTEM DEVELOPMENT PT Chitose Internasional Tbk
△						
△						

Satuan : CM
 Skala : -
 Halaman: 3

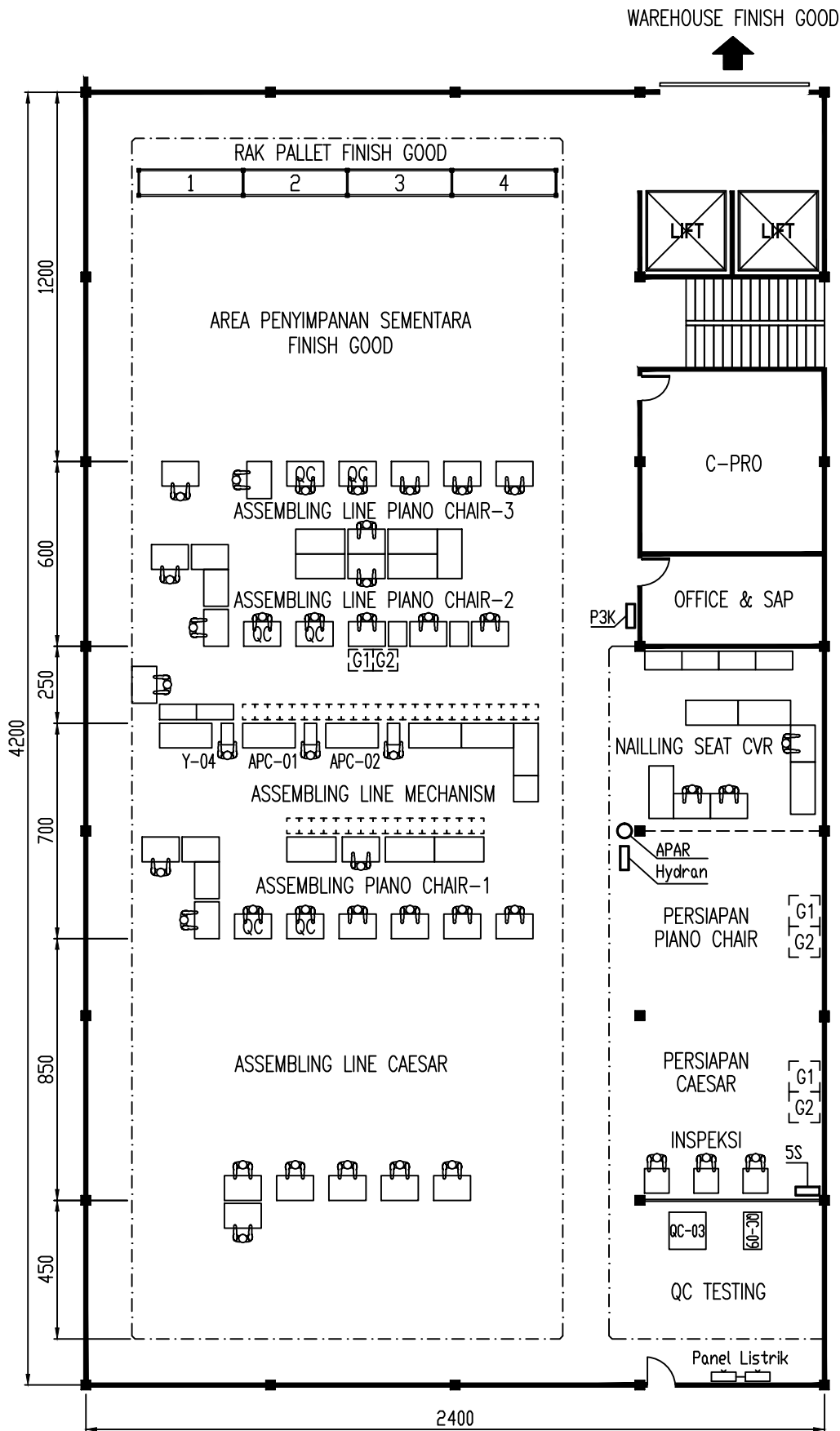

R. ASSEMBLING & QC DC BAROS			
NO.	KODE	MESIN	DIM
1	APC-1	Pneumatic Riveting Machine-01	40x70
2	APC-2	Pneumatic Riveting Machine-02	40x70
3	Y-08	Pneumatic Riveting Machine	40x70
4	QC-3	Pressure Test Back & Seat (Std JIS)	80x120
5	QC-9	Vertical Impact Tes (Std BIFMA)	120x120

REVISI	TANGGAL EFEKTIF	NAMA, PARAF, TANGGAL		
		DIGAMBAR	DIPERIKSA	DISETUJUI
△	22.09.2020	O. Tahya	-	-
△	10.10.2024	O. Tahya	-	-
△				

Gambar :	
R. ASSEMBLING LINE & QC DC BAROS	
MANUFACTURING SYSTEM DEVELOPMENT	
PT Chitose Internasional Tbk	

Satuan : CM
Skala : -
Halaman : -

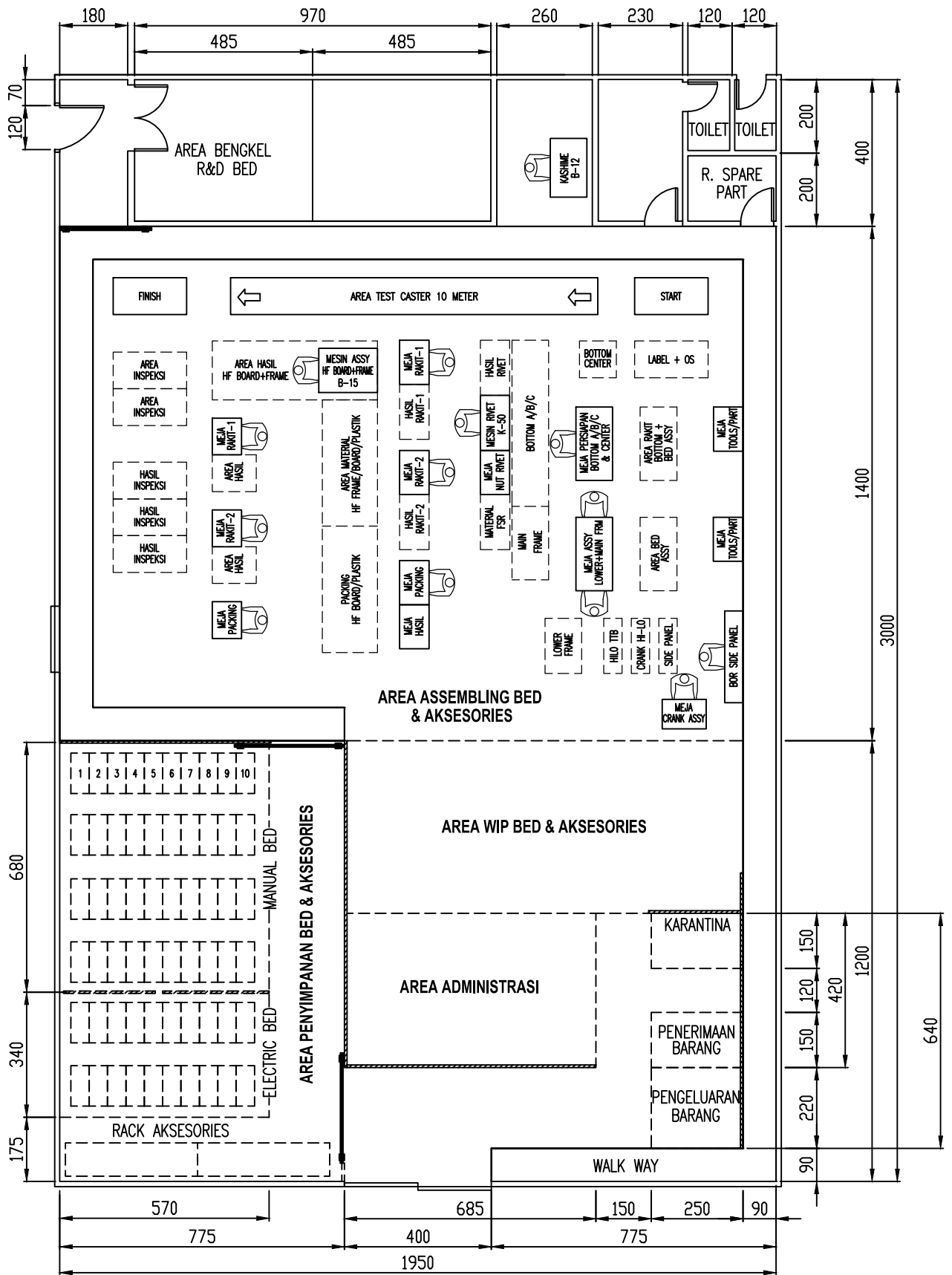

REVISI	TANGGAL EFEKTIF	NAMA, PARAF, TANGGAL		
		DIGAMBAR	DIPERIKSA	DISETUJUI
▲	17.01.2023	O. Tahya		
▲	07.01.2025	O. Tahya		

Gambar : **L A Y O U T**
ASSEMBLING, WIP & FG BED

MANUFACTURING SYSTEM DEVELOPMENT
PT Chitose Internasional Tbk

Skala : -
Halaman : 1

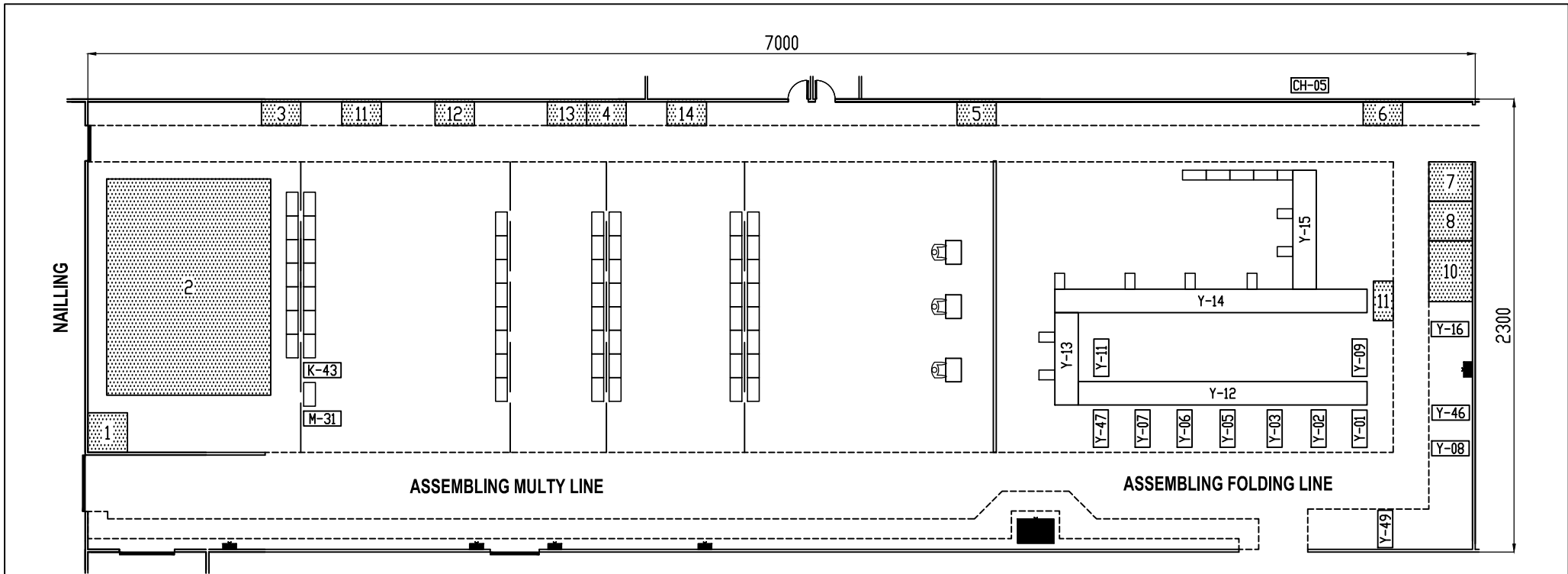

KODE	M E S I N
Y-01	Spot Welder (Daiden)
Y-02	Rivet Setter (Nitto)
Y-03	Rivet Setter (Nitto)
Y-05	Rivet Setter (Yoshikawa Iron)
Y-06	Rivet Setter (Yoshikawa Iron)
Y-07	Rivet Setter (Yoshikawa Iron)
Y-08	Rivet Setter (Nitto)
Y-09	Spot Welder (Daiden)
Y-11	Rivet Setter (Nitto)
Y-12	Conveyor
Y-13	Conveyor
Y-14	Conveyor
Y-15	Conveyor
Y-16	Bor Machine
Y-46	Bor Machine (u/ Bracket Memo KD)
Y-47	Rivet Setter (Nitto)
Y-49	Rivet Setter (Nitto)
K-43	Rivet Setter (Taiwan)
M-31	Rivet Setter (Nitto)
CH-05	Cooling Tower (for Spot Weld)

KODE	KETERANGAN
1	Meja Kepala Seksi Ass. Multy
2	Area Rangka Persiapan Assembling
3	Tempat Sampah & Alat 5S (Multy 4)
4	Tempat Sampah & Alat 5S (Multy 1,2,3)
5	Tempat Sampah & Alat 5S (Paramount)
6	Tempat Sampah & Alat 5S (Folding 1)
7	Meja SAP Assembling
8	Meja Kepala Seksi Ass. Folding
9	Tempat Sampah & Alat 5S (Folding 2)
10	Area Packing Folding-2
11	Area Packing Multy-4
12	Area Packing Multy-2
13	Area Packing Multy-3
14	Area Packing Multy-1

REVISI	TANGGAL EFEKTIF	NAMA, PARAF, TANGGAL			Gambar :
		DIGAMBAR	DIPERIKSA	DISETUJUI	
U	22.11.2024	Q. Tahya			L A Y O U T R. ASSEMBLING LINE MANUFACTURING SYSTEM DEVELOPMENT PT Chitose Internasional Tbk

Satuan : Cm
 Skala : -
 Halaman : -

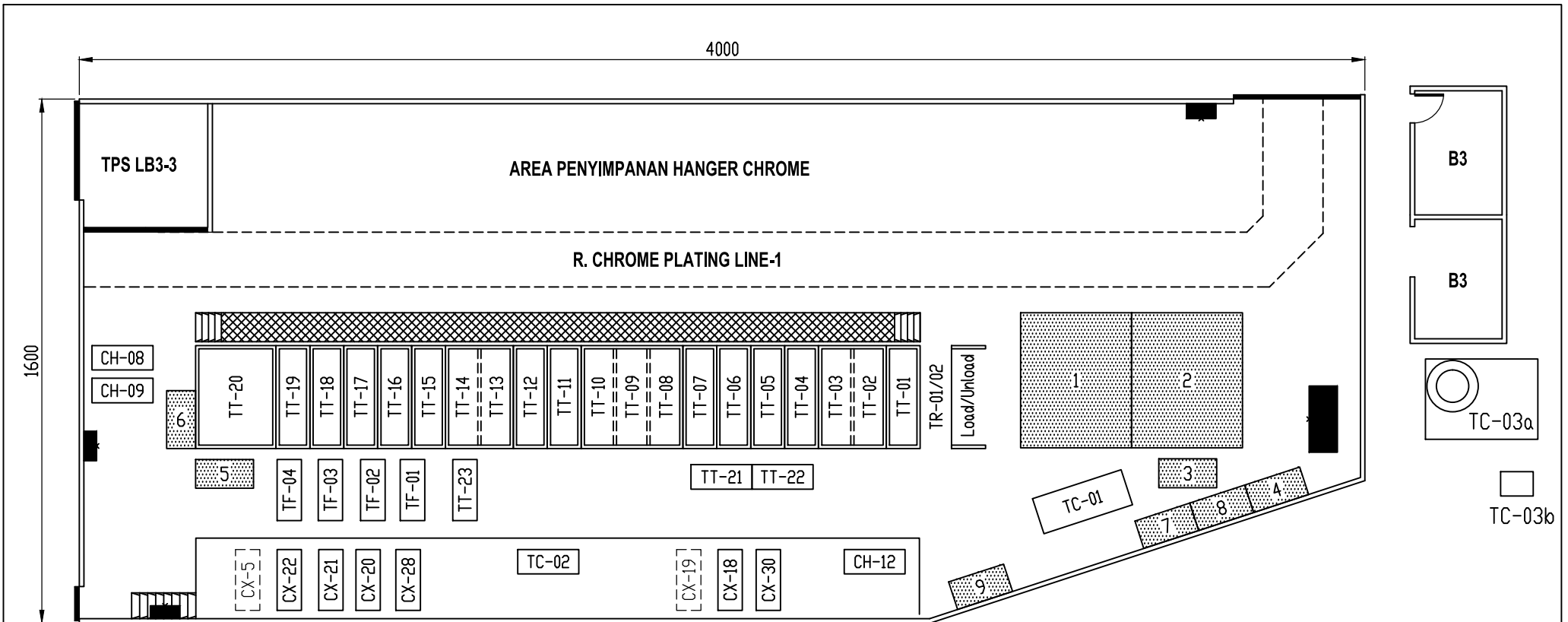

KODE	NAMA MESIN
TC-01	Panel Control Chrome CIM
TC-02	Motor Exhaust Fan (Centrifugal)
TC-03a	Cooling Tower (Liang Chi)
TC-03b	Pompa Sirkulasi Cooling Tower
CH-12	Inline Water Heater
TF-01	Filter Mefiag
TF-02	Filter Mefiag
TF-03	Filter Mefiag
TF-04	Filter Mefiag
TT-01	Tanki Hot Water Rinse
TT-02	Tanki Rinse Chrome-3
TT-03	Tanki Rinse Chrome-2
TT-04	Tanki Rinse Chrome-1 (Drug Out)
TT-05	Tanki Chrome
TT-06	Tanki Electro Cleaner
TT-07	Tanki Alkali/Boiling/Soak Cleaner
TT-08	Tanki Rinse Pickling-1
TT-09	Tanki Rinse Pickling-2
TT-10	Tanki Rinse Pickling-3
TT-11	Tanki Acid Pickling
TT-12	Tanki Acid Dipping

KODE	NAMA MESIN
TT-13	Tanki Rinse Nickle-2
TT-14	Tanki Rinse Nickle-1
TT-15	Tanki Drug Out Nickle
TT-16	Tanki Nickle Plating-1
TT-17	Tanki Nickle Plating-2
TT-18	Tanki Nickle Plating-3
TT-19	Tanki Nickle Plating-4
TT-20	Tanki Slurry
TT-21	Sirkulasi Electro Clean & Pompa
TT-22	Sirkulasi Soak Clean & Pompa
TT-23	Doshing Pump
TR-01	Robot Transporter-1
TR-02	Robot Transporter-2
CH-08	Air Blower
CH-09	Air Blower

KODE	NAMA MESIN
CX-30	Rectifier 5000 A (Sanrex)
CX-18	Rectifier 5000 A (Sanrex)
CX-19	Rectifier 2000 A (Sanrex) - Tidak Aktif
CX-28	Rectifier 2000 A (Sanrex)
CX-20	Rectifier 2000 A (Sanrex)
CX-21	Rectifier 2000 A (Sanrex)
CX-22	Rectifier 2000 A (Sanrex)
CX-05	Rectifier 1500 A (Sanrex) - Tdk Aktif

KODE	KETERANGAN
1	Area Penyimpanan Komponen Mentah
2	Area Penyimpanan Komponen Hasil Chrome
3	Meja ADM / Kepala Chrome
4	Tempat Sampah & Alat 5S
5	Area Penyimpanan Sementara Kertas Filter
6	Rak Penyimpanan Kertas Filter
7	Locker Baju Ganti
8	Papan SOP/Hasil (White Board)
9	Area Dispenser/Galon

	REVISI	TANGGAL EFEKTIF	NAMA, PARAF, TANGGAL			Gambar : L A Y O U T R. CHROME PLATING I (BLK) MANUFACTURING SYSTEM DEVELOPMENT PT Chitose Internasional Tbk
	▲	22.11.2024	DIGAMBAR	DIPERIKSA	DISETJUI	
	▲		Q. Tahya			
	▲					
Satuan : Cm Skala : - Halaman : -						

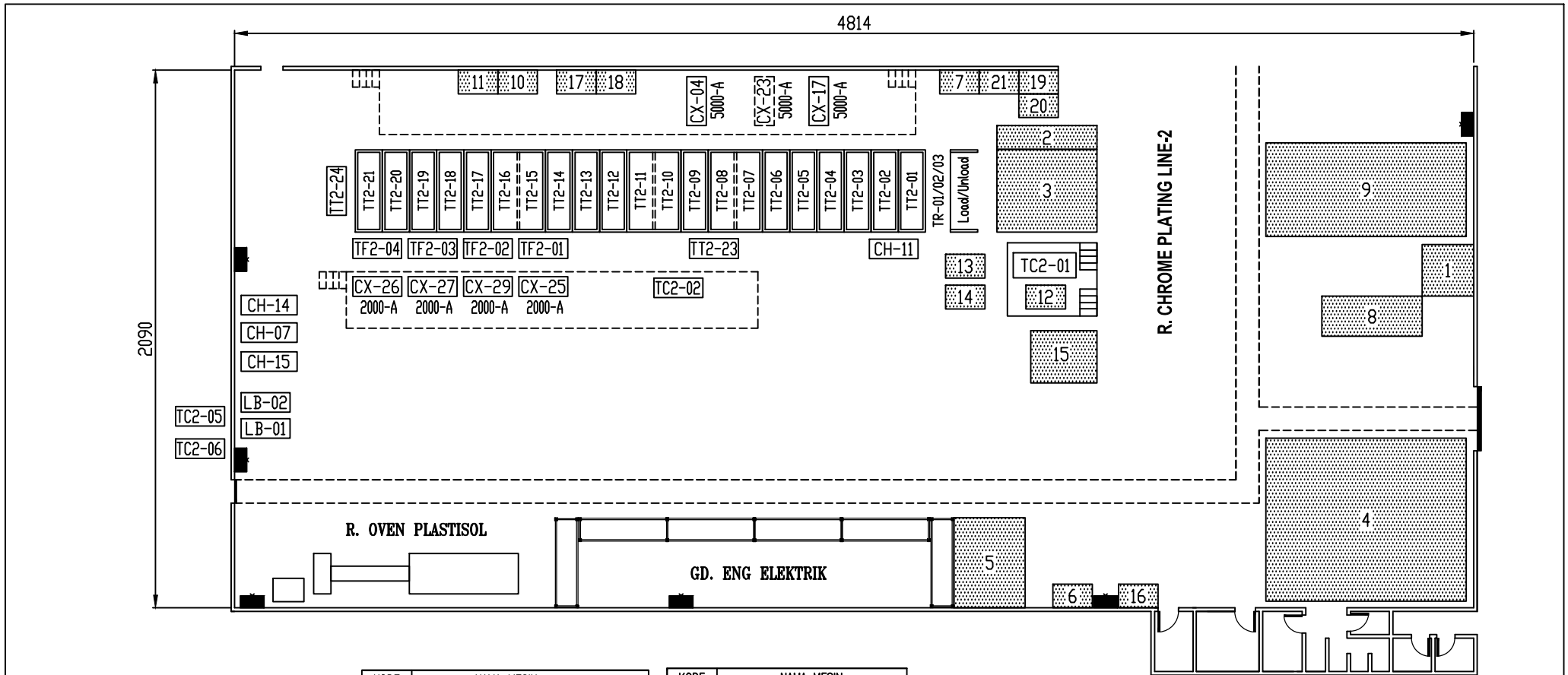

KODE	KETERANGAN
1	Meja SAP Chrome
2	Area Penyimpanan Komponen Mentah
3	Area Penyimpanan Komponen Mentah
4	Area Penyimpanan Hanger
5	Area Penyimpanan Hanger
6	Area G2
7	Tempat Sampah & Alat 5S
8	Area Penyimpanan Komponen Hasil Chrome
9	Area Penyimpanan Hasil Produksi
10	Rack Kimia
11	Tools Box
12	Area Penyimpanan Komponen Mentah Leg CSR
13	Area Penyimpanan Komponen Mentah Leg CSR
14	Area Penyimpanan Komponen Chrome Leg CSR
15	Locker Baju Ganti
16	Tempat Sampah & Alat 5S
17	Tempat Sampah & Alat 5S
18	Tempat Sampah B3 (Sarung Tangan Bekas)
19	Papan SOP/Hasil (White Board)
20	Meja ADM
21	Area Dispenser/Galon

KODE	NAMA MESIN
TT2-01	T. Hot Water Rinsing
TT2-02	T. Rinse Chrome-01
TT2-03	T. Rinse Chrome-02
TT2-04	T. Reduction
TT2-05	T. Drug Out Chrome
TT2-06	T. Chrome
TT2-07	T. Rinse nickle-02
TT2-08	T. Electro Cleaner
TT2-09	T. Soak Clean
TT2-10	T. Rinse Electro-01/Alkali-01
TT2-11	T. Rinse Electro-02/Alkali-02/Pickling-02
TT2-12	T. Rinse Pickling-01
TT2-13	T. Pickling
TT2-14	T. Acidip
TT2-15	T. Rinse Acidip
TT2-16	T. Rinse Nickle-01
TT2-17	T. Dragout Nickle
TT2-18	T. Nickle 01
TT2-19	T. Nickle 02
TT2-20	T. Nickle 03
TT2-21	T. Nickle 04

KODE	NAMA MESIN
TT2-22	T. El Clean Circulation & Pump
TT2-23	T. Soak Clean Circulation & Pump
TT2-24	Dozing Pump
TC2-01	Mesin Chrome
TC2-02	Motor Exhaust Fan
TC2-05	Cooling Tower
TC2-06	Pompa Sirkulasi Cooling Tower
TF2-01	Mefiag Filter-1
TF2-02	Mefiag Filter-2
TF2-03	Mefiag Filter-3
TF2-04	Mefiag Filter-4
TR-01	Robot-1
TR-02	Robot-2
TR-03	Robot-3

KODE	NAMA MESIN
CH-11	Inline Water Heater
CH-14	Air Blower-1 (Fu Tsu)
CH-07	Air Blower-2 (Ring Blower)
CH-15	Air Blower-3 (Fu Tsu)
CX-04	Rectifier 5000 A (Sanrex)
CX-17	Rectifier 5000 A (Sanrex)
CX-23	Rectifier 5000 A (Sanrex)-Tdk Aktif
CX-25	Rectifier 2000 A (Sanrex)
CX-26	Rectifier 2000 A (Sanrex)
CX-27	Rectifier 2000 A (Sanrex)
CX-29	Rectifier 2000 A (Sanrex)

REVISI	TANGGAL EFEKTIF	NAMA, PARAF, TANGGAL			Gambar :
		DIGAMBAR	DIPERIKSA	DISETUJUI	
Δ	22.11.2024	O. Taha	.	.	L A Y O U T R. CHROME PLATING II (DPN) MANUFACTURING SYSTEM DEVELOPMENT PT Chitose Internasional Tbk
Δ					
Δ					

Satuan : CM
 Skala : -
 Halaman : -

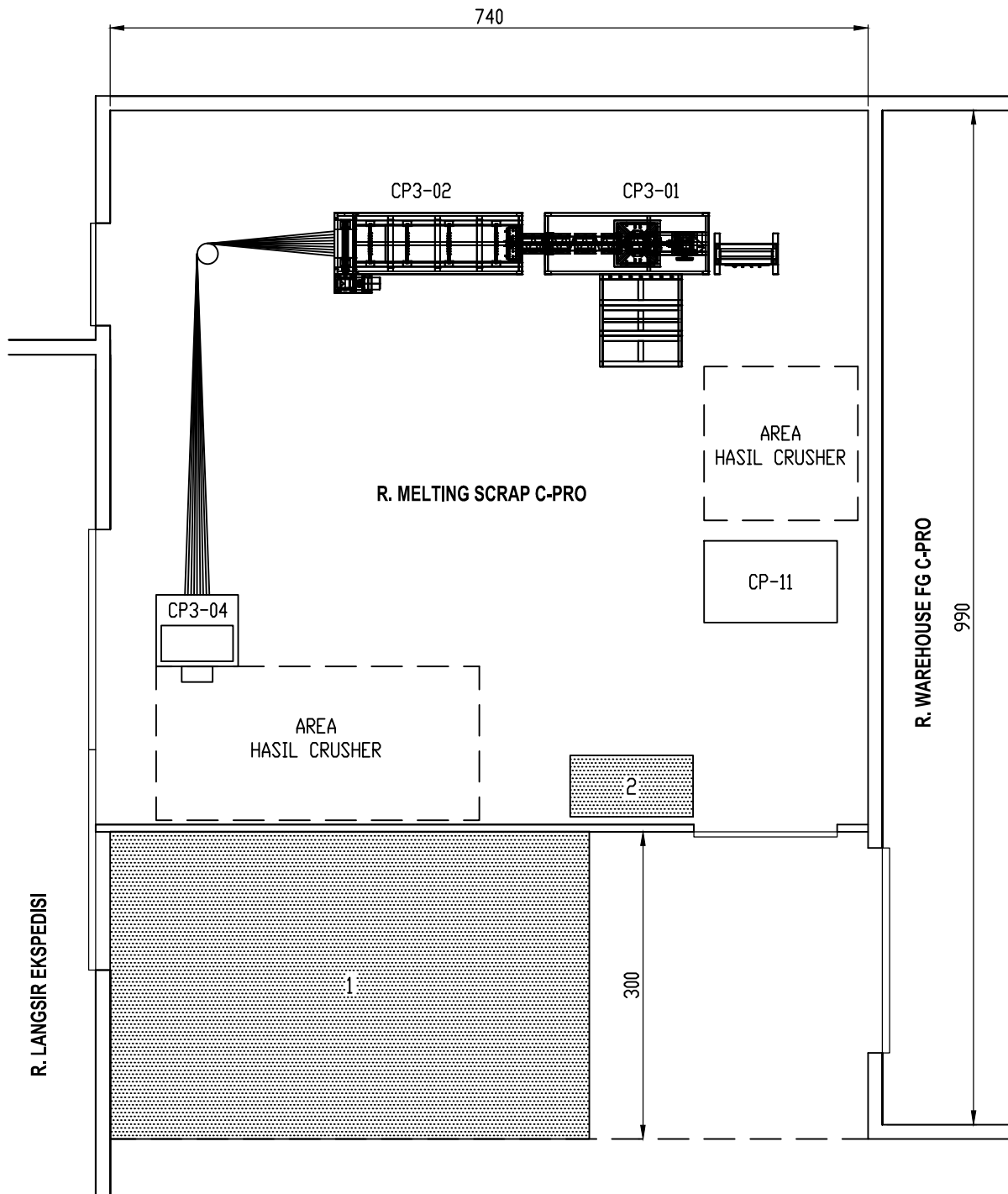

KODE	M E S I N
CP3-01	Melting
CP3-02	Water Coller Tank & Roller
CP3-03	Cutting (New)
CP-11	Crusher

KODE	KETERANGAN
1	Area Hasil Melting (Daur Ulang)
2	Tempat Sampah & Alat 5S

U ←	REVISI	TANGGAL EFEKTIF	NAMA, PARAF, TANGGAL			Gambar : L A Y O U T R. MELTING SCRAP C-PRO MANUFACTURING SYSTEM DEVELOPMENT PT Chitose Internasional Tbk
			DIGAMBAR	DIPERIKSA	DISETUJUI	
	△	22.11.2024	O. Talya	.	.	
	△					Setoran : CM Skala : - Halaman : -

R. C-PRO LINE 1	
KODE	MESIN
CP-01	Extruder
CP-02	Panel Control Extruder
CP-03	Quenching
CP-04	Annealing
CP-05	Cutting
CP-06	Panel Ctrl Quenching-Annealing-Cutting
CP-07	Panel Control Cutting
CP-08	Hoist
CP-09	Oven Nozzle
CP-10	Panel Oven Nozzle
R. C-PRO LINE 2	
KODE	MESIN
CP2-01	Extruder
CP2-02	Panel Control Extruder
CP2-03	Quenching
CP2-04	Annealing
CP2-05	Cutting
CP2-06	Panel Ctrl Quenching-Annealing-Cutting
CP2-07	Panel Control Cutting

KODE	KETERANGAN
1	Meja ADM & Kepala C-Pro
2	Papan Informasi
3	Area Dispenser/Galon/Air Minum
4	SOP
5	P3K
6	Tools Box
7	Area Hasil
8	Area Timbangan / Inspeksi
9	Tempat Sampah & Alat 5S
10	Area Bahan Baku
11	Area Penyimpanan Roda Hoist
12	Rak Plate Aluminium
13	Area Penyimpanan APD

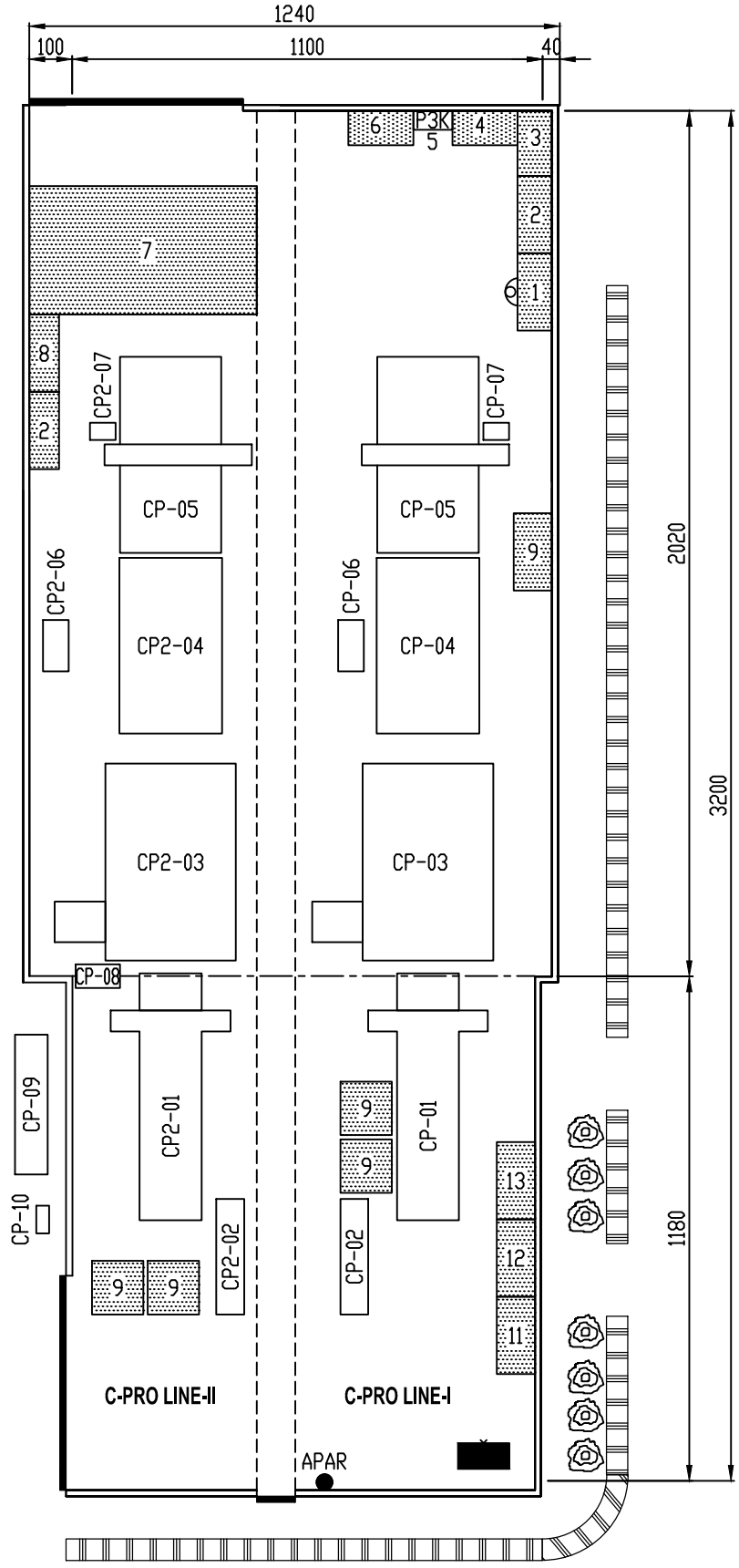

	REVISI	TANGGAL EFEKTIF	NAMA, PARAF, TANGGAL			Gambar : LAYOUT R. C-PRO MANUFACTURING SYSTEM DEVELOPMENT PT Chitose Internasional Tbk
	▲	22.11.2024	DIGAMBAR	DIPERIKSA	DISETUJUI	
	▲		O. Tahya			
	▲					

Satuan : CM
 Skala : -
 Halaman : -

KODE	MESIN	KODE	MESIN	KODE	MESIN
K-03	Double Bending KD Yamato	K-41	Rivet Setter (Taiwan)	K-58	Pierching KB Cosmo
K-04	Radius Press Machine KD YA	K-44	Rivet Setter (Nitto)	K-59	Double Bending Taiwan (YLM)
K-05	Fierching KD Yamato	K-45	Spot Welder Seat (Panasonic)	K-61	Double Bending Taiwan (YLM)
K-06	Butseem Welder (UTO)	K-46	Rivet Setter (Nitto)	K-62	Bor Machine KD Memo Yamato-Cosmo
K-07	Butseem Welder (UTO)	K-47	Rivet Setter (Yoshikawa Iron)	K-63	Fierching KB Cosmo H (New Feb 2023)
K-09	Double Bending KB Yamato	K-48	Rivet Setter (Nitto)	B-01	Auto CO2 Welder (Panasonic)
K-10	Fierching KB Yamato	K-49	Bor Machine (Manual)	M-39	Press 16-T (u/ Rack Frame)
K-11	Fierching Water Hole	K-53	Multy Spot Welder Seat (ex Sankei)	M-42	Fierching Water Hole KB Cosmo
K-12	Auto CO2 Welder (Panasonic)	K-55	Double Pierching KD Cosmo	T-03	Rivet Setter (Nitto)
K-21	Spot Welder (Daiden)	K-56	Flash Butt Welding Machine (Golden Spot)	RJ-01	Rivet Setter (Nitto)

KODE	KETERANGAN
1	APAR
2	Area Tabung Gas Kosong
3	Meja ADM/Kepala
4	Kotak P3K
5	Papan SOP
6	Area Penyimpanan Jig Inspeksi
7	Area G1/G2
8	Tempat Sampah B3
9	Area Pemasangan Plastic Cap/Shoes

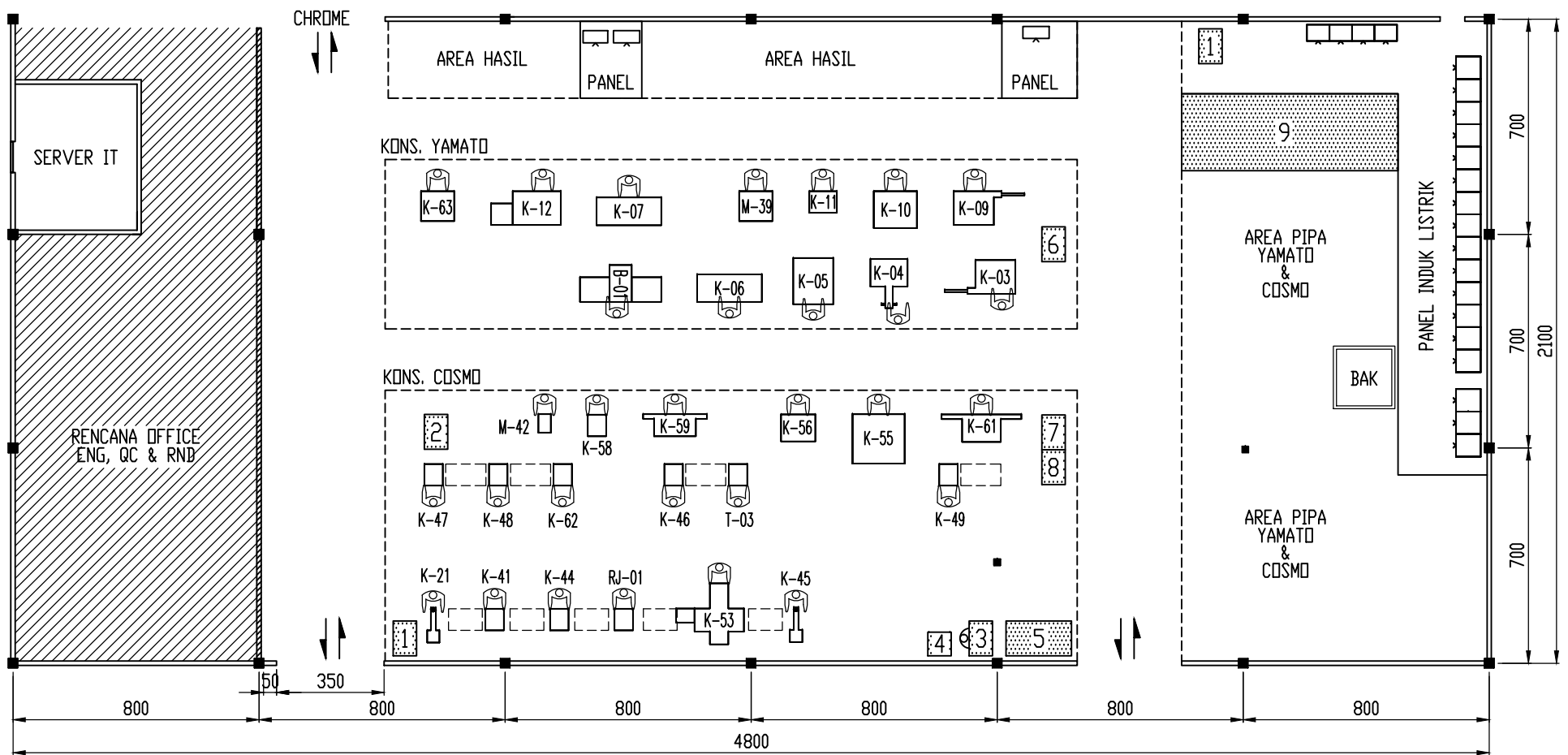

U	REVISI	TANGGAL EFEKTIF	NAMA, PARAF, TANGGAL			Gambar : L A Y O U T KONS FOLDING (YAMATO & COSMO) MANUFACTURING SYSTEM DEVELOPMENT PT Chitose Internasional Tbk
	▲	09.01.2025	DIGAMBAR	DIPERIKSA	DISETUJUI	
	▲	15.01.2025	O. Tjahyo			
	▲	20.02.2025	O. Tjahyo			

Satuan : CM
 Skala : NTS
 Halaman: --

KODE	M E S I N
M-02	Inclinable Press 40 Ton
M-03	Inclinable Press 40 Ton
M-04	Inclinable Press 25 Ton
M-05	Inclinable Press 25 Ton
M-06	Inclinable Press 16 Ton
M-07	Inclinable Press 16 Ton
M-08	Inclinable Press 16 Ton
M-09	Inclinable Press 16 Ton
M-12	Fine Bending Chiwork
M-13	Fine Bending Japan
M-17	Double Bending ex Japan
M-19	Bending Horizontal Soco
M-21	Roll Bending Taiyo
M-22	Double Side Bending Taiwan (YLM)
M-23	Double Side Bending Taiwan (YLM)
M-24	Double Side Bending Taiwan (YLM)
M-27	Double Bending Taiwan (YLM)
M-28	Roll Bending
M-29	Shringking Machine (YLM)
M-30	Double Shringking Machine (YLM)
M-34	Hoist
M-35	Pompa Sirkulasi Cooler
M-36	Inclinable Press 63 Ton
M-38	Inclinable Press 16 Ton
M-40	CNC Bending (R-Side)
M-41	Pompa Sirkulasi Cooler
M-43	CNC Bending (L-Side)
M-44	Cooling Tower & Pump
M-45	Press Seyi 25 Ton (SNI 25)
M-46	Press Seyi 45 Ton (SNI 45)
M-48	Double Side Bending Taiwan (YLM)
M-49	CNC Bending (L-Side)
M-50	CNC Bending (R-Side)
M-51	Inclinable Press 10 Ton
M-52	Pierching Shoes Ayumi Desk
K-52	Butseam Welder
K-57	Press Vertical KD Cosmo

KODE	KETERANGAN
1	Meja Kepala + Papan SOP
2	Meja ADM/SAP
3	Dispenser/Galon/Air Minum
4	Tempat Sampah B3
5	Alat Kebersihan 5S
6	Area Bahan Baku Pipa
7	Area G2
8	Area WIP Sisa
9	Area Penyimpanan Jig Inspeksi
10	Tools Box
11	Locker Baju Ganti & APD

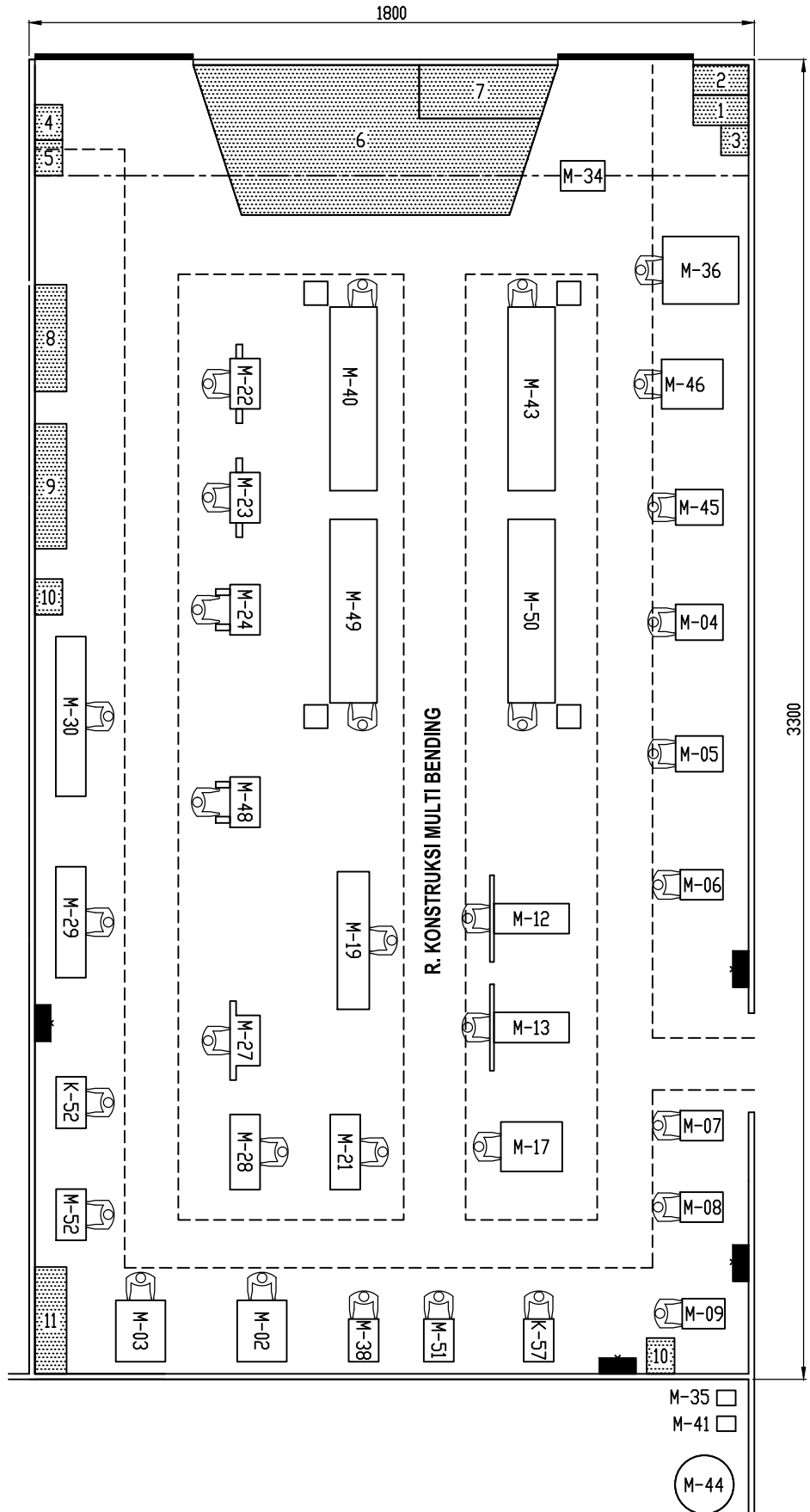

REVISI	TANGGAL EFEKTIF	NAMA, PARAF, TANGGAL			Gambar :
		DIGAMBAR	DIPERIKSA	DISETUJUI	
U	22.11.2024	O. Tahya			L A Y O U T R. KONST. MULTI BENDING MANUFACTURING SYSTEM DEVELOPMENT PT Chitose Internasional Tbk

Skala : -
 Halaman : -

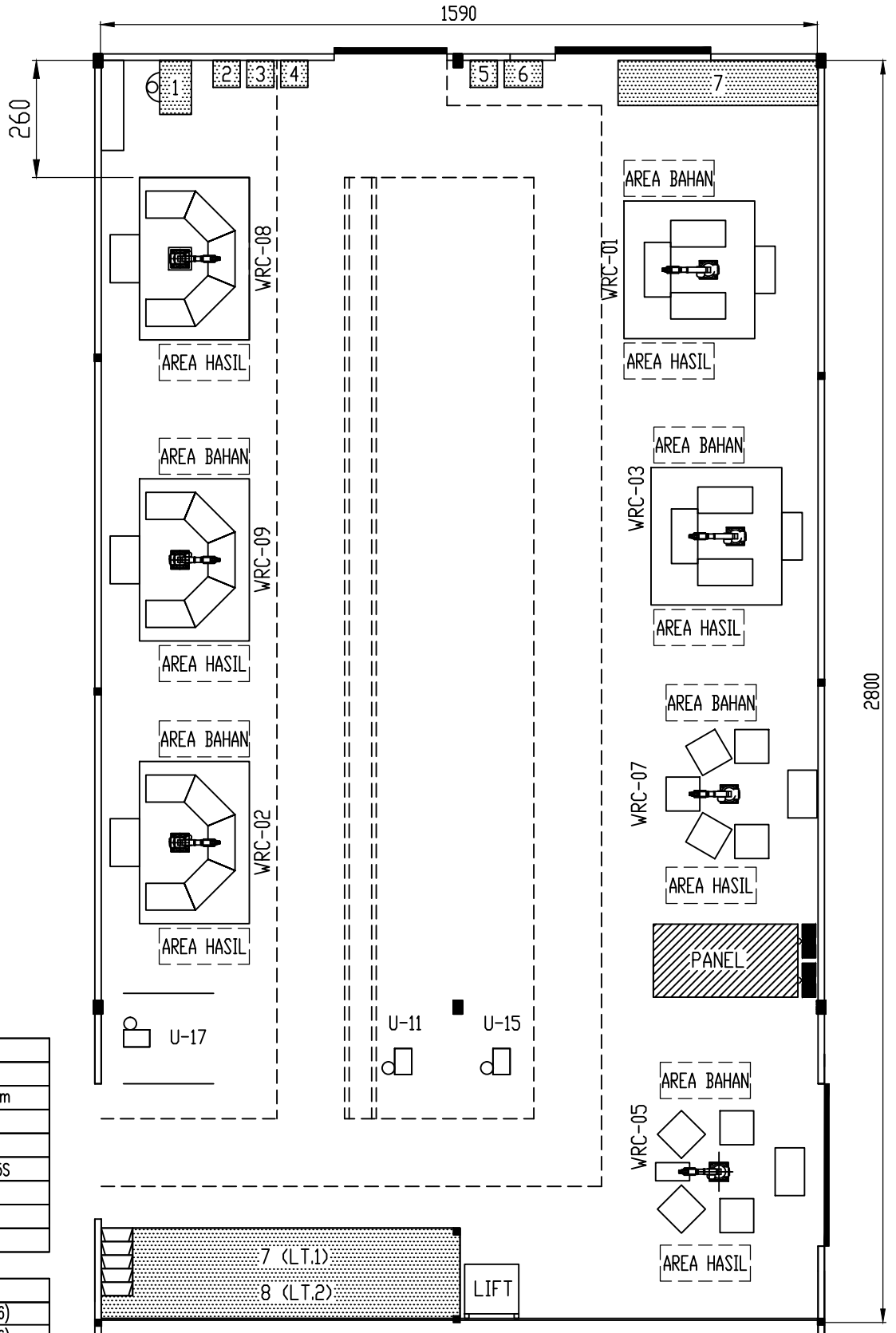

KODE	KETERANGAN
1	Meja Kepala
2	Dispenser/Galon/Air Minum
3	Tempat Kawat Las
4	Kotak P3K & APAR
5	Tempat Sampah & Alat 5S
6	Area G2
7	Area Welding Jig
8	Locker & APD (Lt.2)

KODE	MESIN
WRC-01	Robot Welder (VR-006)
WRC-02	Robot Welder (VR-006)
WRC-03	Robot Welder (VR-006)
WRC-05	Robot Welder (TA-1400)
WRC-07	Robot Welder (TA-1400)
WRC-08	Robot Welder (TA-1400)
WRC-09	Robot Welder (TA-1400)
B-04	Auto CO2 Welder
U-07	Auto CO2 Welder
U-11	Auto CO2 Welder
U-12	Auto CO2 Welder
U-15	Auto CO2 Welder
U-17	Auto CO2 Welder
U-19	Auto CO2 Welder

REVISI	TANGGAL EFEKTIF	NAMA, PARAF, TANGGAL		
		DIGAMBAR	DIPERIKSA	DISETUJUI
1	22.11.2024	O. Taha		
2				
3				

Gambar : **L A Y O U T
K O N S . M U L T I L A S**

**MANUFACTURING SYSTEM DEVELOPMENT
PT Chitose Internasional Tbk**

Satuan : CM
Skala : -
Halaman : -



KODE	M E S I N
WRC-04	Panasonic Robot Welder (VR-008)
WRC-06	Panasonic Robot Welder (VR-008)
B-02	Auto CO2 Welder (Panasonic, 350 KR1)
B-03	Auto CO2 Welder (Panasonic, 350 KR1)
B-05	Auto CO2 Welder (Panasonic, 350 KR1)
B-08	Rotary Welder
B-08a	Auto CO2 Welder (Panasonic, 350 KR1)
B-19	Bor Machine (West Lake)
B-22	Bor Machine (West Lake)
B-23	Bor Machine
B-25	Auto CO2 Welder (Panasonic, 350 KR1)
B-26	Auto CO2 Welder (Panasonic, 350 KR1)
U-03a	Auto CO2 Welder (Panasonic, 350 KR1)
U-09	Auto CO2 Welder (Panasonic, 350 KR1)
U-10	Auto CO2 Welder (Panasonic, 350 KR1)
U-16	Auto CO2 Welder (Panasonic, 350 KR1)
U-20	Auto CO2 Welder (Panasonic, 350 KR1)
U-21	Auto CO2 Welder (Panasonic, 350 KR1)
APC-05	Machine Bor Westlake + Tapping Attach

R. PRESSING	
KODE	M E S I N
P-04	Inclinable Press 63 Ton
P-05	Inclinable Press 63 Ton
P-08	Inclinable Press 63 Ton
P-09	Inclinable Press 63 Ton
P-10	Inclinable Press 40 Ton
P-11	Inclinable Press 25 Ton
P-12	Inclinable Press 25 Ton
P-13	Inclinable Press 16 Ton
M-01	Inclinable Press 40 Ton
M-33	Bor Machine

R. GUDANG RONGSOK	
KODE	M E S I N
O-06	Press Rongsok (G2)

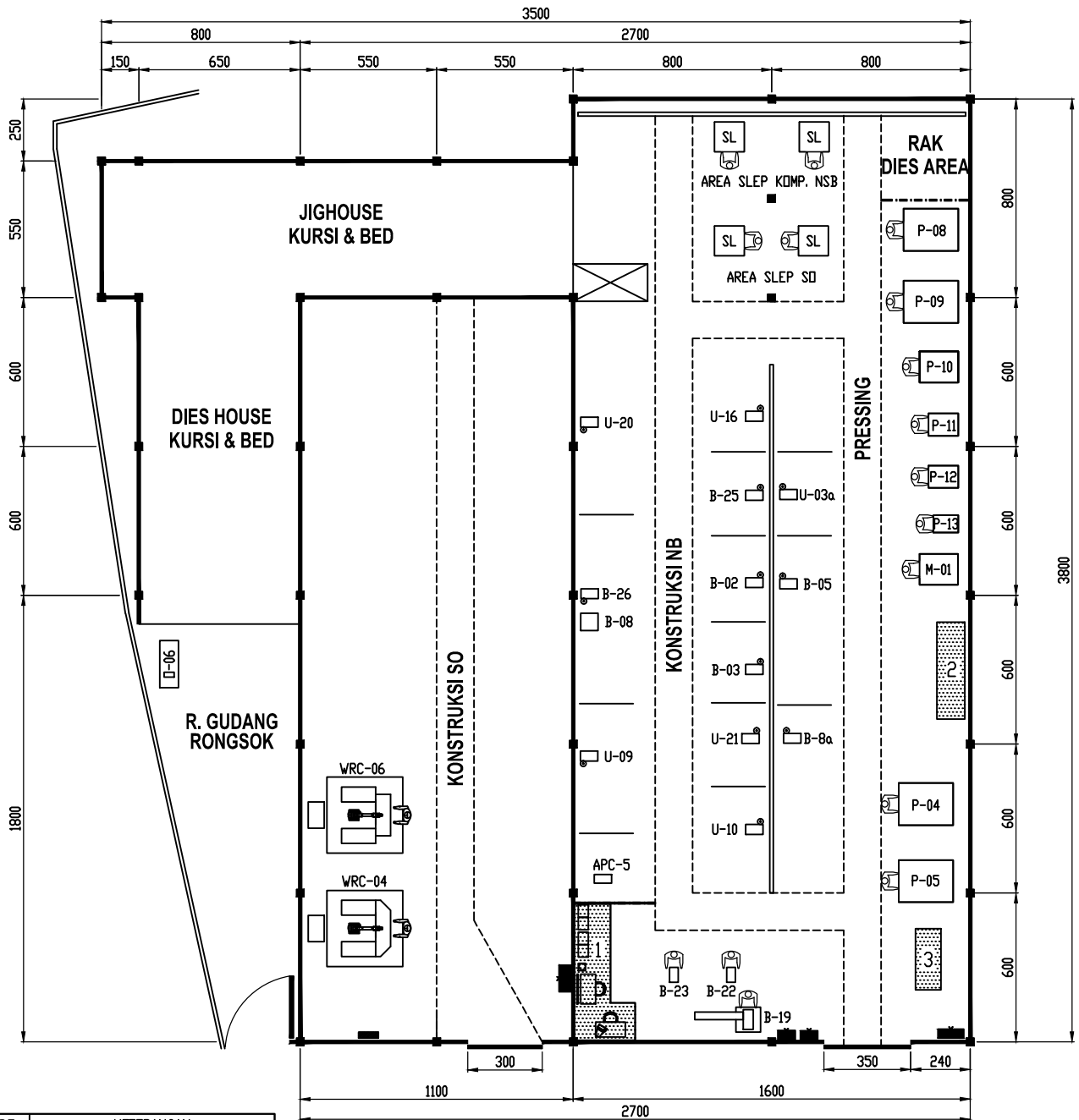

KODE	KETERANGAN
1	Meja Kepala Meja SAP/ADM Papan SOP
2	Loker Baju Ganti
3	APD

REVISI	TANGGAL EFEKTIF	NAMA, PARAF, TANGGAL			Gambar :
		DIGAMBAR	DIPERIKSA	DISETUJUI	
U	22.11.2024	O. Tolya			L A Y O U T KONS. NB & PRESSING MANUFACTURING SYSTEM DEVELOPMENT PT Chitose Internasional Tbk

Satuan : CM
Skala : -
Halaman : -

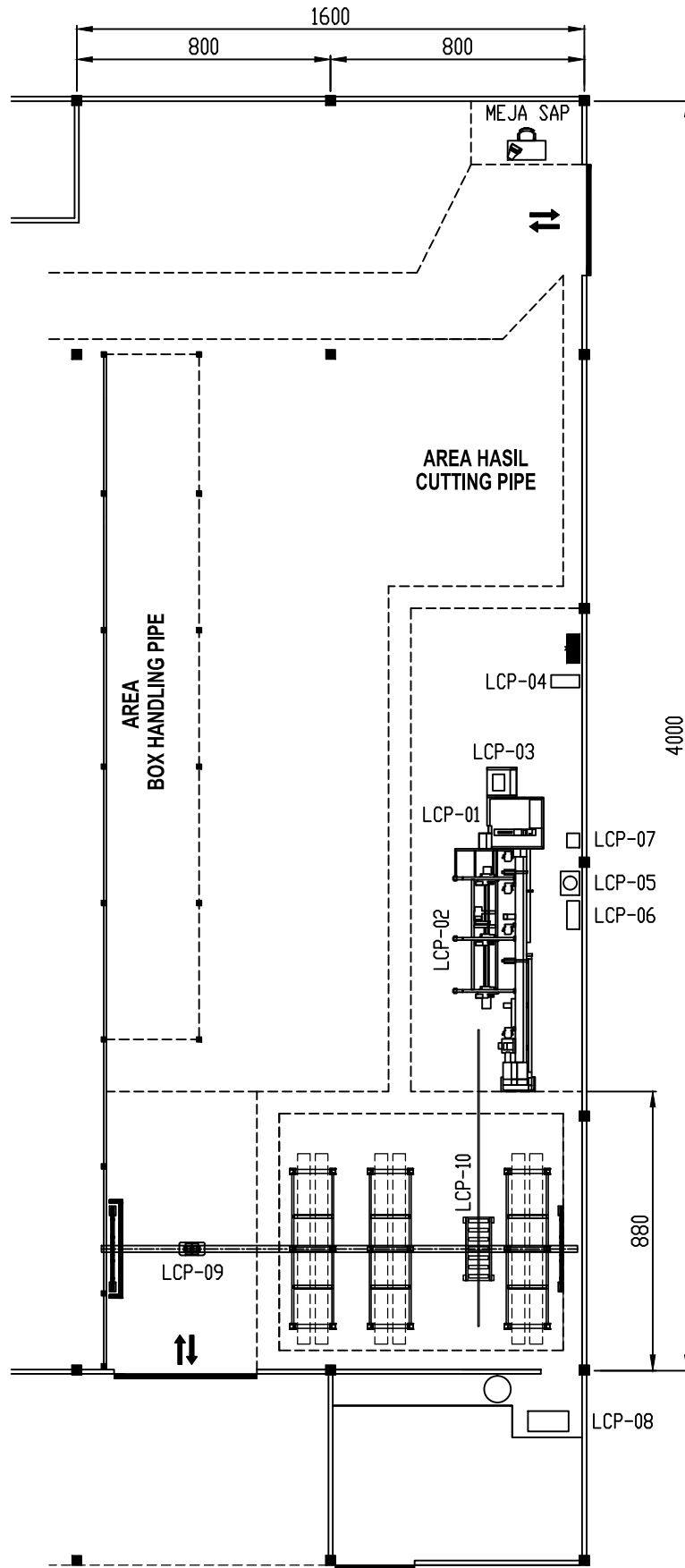

KODE	MESIN
LCP-01	Mesin Laser Cutting Pipe
LCP-02	Loader Pipe
LCP-03	Guide Roll Pipe
LCP-04	Stabilizer
LCP-05	Water Chiller
LCP-06	Travo
LCP-07	Exhaust Fan (Centrifugal Fan)
LCP-08	Screw Air Compressor
LCP-09	Hoist 3T
LCP-10	Trolley Conveyor

REVISI	TANGGAL EFEKTIF	NAMA, PARAF, TANGGAL			Gambar :
		DIGAMBAR	DIPERIKSA	DISETUJUI	
Δ	14.12.2024	O. Taha			L A Y O U T R. LASER CUTTING PIPE MANUFACTURING SYSTEM DEVELOPMENT PT Chitose Internasional Tbk
Δ					
Δ					

Satuan : CM
 Skala : -
 Halaman: -

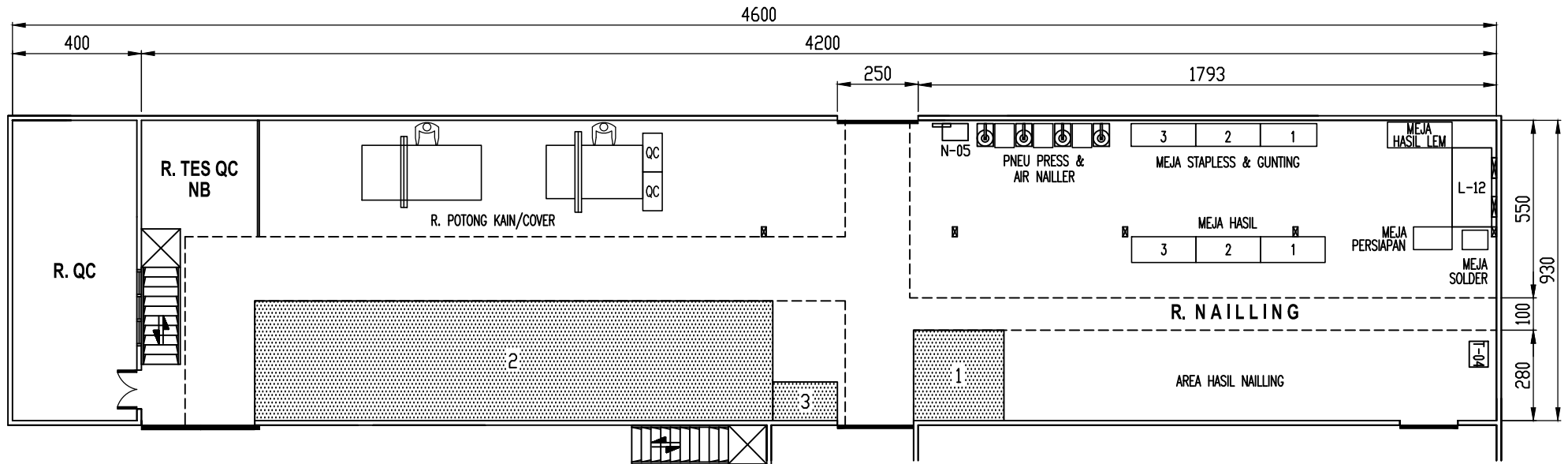

R. NAILLING	
KODE	M E S I N
L-02	Pneumatic Press & Air Nailer
L-06	Pneumatic Press & Air Nailer
L-07	Pneumatic Press & Air Nailer
L-09	Pneumatic Press & Air Nailer
L-12	Spray Glue & Both
L-13	Pneumatic Press & Air Nailer
N-05	Wire Thigner
T-04	Strapping Machine-2

KODE	KETERANGAN
1	Meja SAP & Barang Komponen Gudang
2	Area Persiapan Assembling (Dari Gudang)
3	Tempat Sampah & Alat 5S

U ←	REVISI	TANGGAL EFEKTIF	NAMA, PARAF, TANGGAL			Gambar : L A Y O U T R. NAILLING & PERSIAPAN ASSEMBLING Saluran : CM Skala : - Halaman : -
			DIGAMBAR	DIPERIKSA	DISETUJUI	
	Δ	22.11.2024	O. Tahya	.	.	
	Δ					
	Δ					
MANUFACTURING SYSTEM DEVELOPMENT PT Chitose Internasional Tbk						

R. PRETREATMENT			
KODE	MESIN	KODE	MESIN
C-01a	Inline Water Heater	C-02h	Tanki Rinse-4 & Pompa
C-02	Pretreatment Spray Line	C-02i	Tanki Passivation & Pompa
C-02a	Pompa-01 (Circulating Pump)	C-02j	Exhaust Fan for Conversion Coating
C-02b	Tanki Pre-Degrease & Pompa (Heat)	C-02k	Exhaust Fan for Degreasing
C-02c	Tanki Degrease & Pompa	C-03	Burner-2 (Drying Oven)
C-02d	Tanki Rinse-1 & Pompa	C-04	Oven Drying Treatment Line
C-02e	Tanki Rinse-2 & Pompa	C-04a	Circulation Fan
C-02f	Tanki Rinse-3 & Pompa	C-04b	Exhaust fan
C-02g	Tanki Conversion Coating & Pompa	C-05	Conveyor Pretreatment

R. POWDER COATING			
KODE	MESIN	KODE	MESIN
C-06	Powder Booth-1 (Double) + Control Unit + Spray Gun	C-15	Powder Booth-10 (Double) + Control Unit + Spray Gun
C-07	Powder Booth-2 (Single) + Control Unit + Spray Gun	C-16	Conveyor Painting
C-08	Powder Booth-3 (Single) + Control Unit + Spray Gun	C-17	Burner-3 (Curing Oven)
C-09	Powder Booth-4 (Single) + Control Unit + Spray Gun	C-18	Paint Curing Oven
C-11	Powder Booth-6 (Single) + Control Unit + Spray Gun	C-18a	Circle Fan / Stirring Unit
C-12	Powder Booth-7 (Single) + Control Unit + Spray Gun	C-18b	Exhaust Flue Gas Duct
C-13	Powder Booth-8 (Single) + Control Unit + Spray Gun	C-18c	Cooling Fan (cooling zone)
C-14	Powder Booth-9 (Single) + Control Unit + Spray Gun	C-19	Spray booth touch up

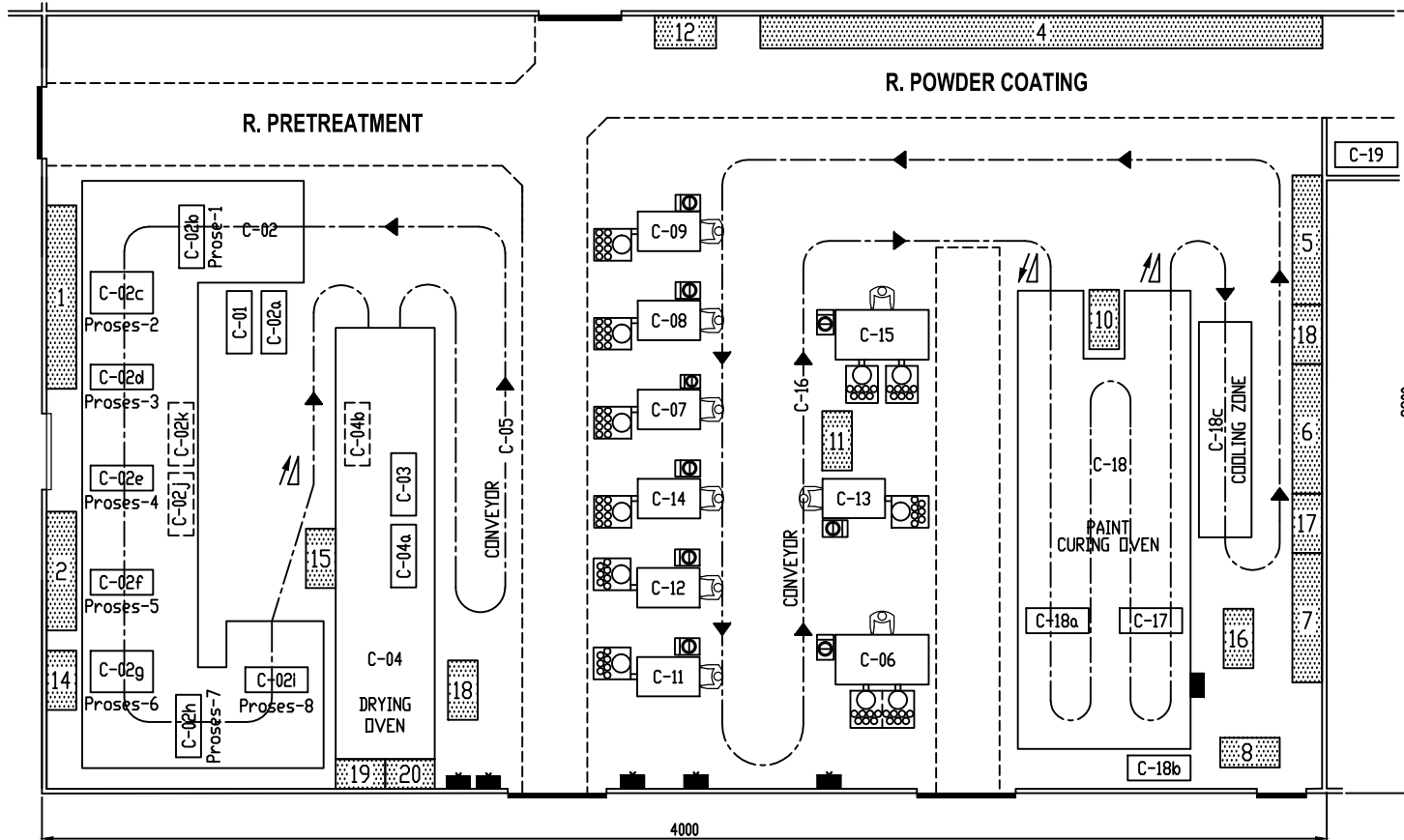

KODE	KETERANGAN
1	Area Penyimpanan Cat Powder
2	Area Penyimpanan Cat Powder
3	Meja SAP
4	Area Hasil Cat
5	Area Pemasangan Shoes Plastik
6	Tempat Sampah & Alat 5S
7	Area Penyimpanan Sementara Leg Rolland
8	Area Penyimpanan Shoes Plastik
9	Area Penyimpanan Hanger Cat
10	Area Penyimpanan Balok NSB
11	Booth Portable
12	Area Penyimpanan Vacum Cleaner
13	Tempat Sampah & Alat 5S
14	Tempat Limbah B3 (Dakron & Filter)
15	Locker Baju Ganti
16	Area Hasil Produksi Rolland
17	Area Dispenser/Galon/Air Minum
18	Area Dispenser/Galon/Air Minum
19	Tempat Limbah B3 (Sarung Tangan)
20	Area Hanger Pretreatment

	REVISI	TANGGAL EFEKTIF	NAMA, PARAF, TANGGAL			Gambar : LAYOUT R. POWDER COATING MANUFACTURING SYSTEM DEVELOPMENT PT Chitose Internasional Tbk
	Δ	22.11.2024	DIGAMBAR	DIPERIKSA	DISETUJUI	
	Δ		O. Tahya			
	Δ					

Satuan : CM
 Skala : -
 Halaman : -

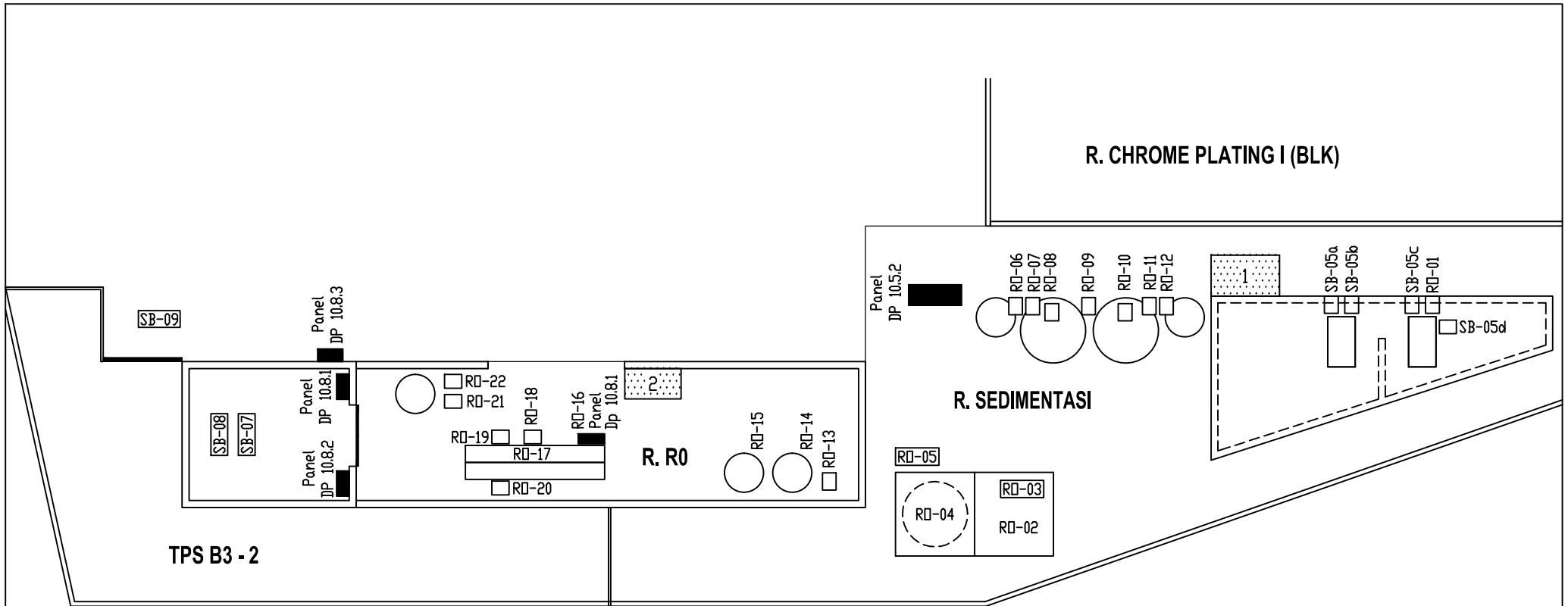

R. CHROME PLATING I (BLK)

R. SEDIMENTASI

R. R O

TPS B3 - 2

R. SEDIMENTASI	
KODE	M E S I N
RO-01	Motor Pompa-1
RO-02	Bak Sedimentasi
RO-03	Mixer-1
RO-04	Cooling Tower
RO-05	Motor Pompa-2
RO-06	Doshing Pump-1 (Kuning)
RO-07	Doshing Pump-2 (Kuning)
RO-08	Mixer-2
RO-09	Doshing Pump-3 (Biru)
RO-10	Mixer-3
RO-11	Doshing Pump-4 (Biru)
RO-12	Doshing Pump-5 (Biru)

R. R O	
KODE	M E S I N
RO-13	Feed Pump Pass RO
RO-14	Multi Media Filter / Sand Filter Tank
RO-15	Active Carbon Filter Tank
RO-16	Panel Control System RO
RO-17	Membrane Housing RO
RO-18	Cartridge Filter-1
RO-19	High Pressure Pump Pass RO-1
RO-20	High Pressure Pump Pass RO-2
RO-21	Cartridge Filter-2
RO-22	CIP (Cleaning In Place) Pump

SUMUR BOR & POMPA	
KODE	M E S I N
SB-04	Pompa Bak Reservoir-1 (Depan Gdq. Baru)
SB-05a	Pompa Bak Reservoir-2 (Blk Chrome-1)
SB-05b	Pompa Bak Reservoir-3 (Blk Chrome-1)
SB-05c	Pompa Bak Reservoir-4 (Blk Chrome-1)
SB-05d	Pompa Bak Reservoir-5 (Blk Chrome-1)
SB-06	Pompa Sumur (Blk Gudang IC)
SB-07	Pompa Ground Reservoir-1
SB-08	Pompa Ground Reservoir-2
SB-09	Pompa Sumur (Lap. Voly)

KODE	KETERANGAN
1	Area Penyimpanan Kimia PAC
2	Tempat Sampah & Alat 5S

	REVISI	TANGGAL EFEKTIF	NAMA, PARAF, TANGGAL			Gambar : L A Y O U T R. BWR0 & SUMUR MANUFACTURING SYSTEM DEVELOPMENT PT Chitose Internasional Tbk
	△	22.11.2024	0. Talya	DIGAMBAR	DIPERIKSA	
	△					
	△					
						Satuan : CM Skala : - Halaman: -

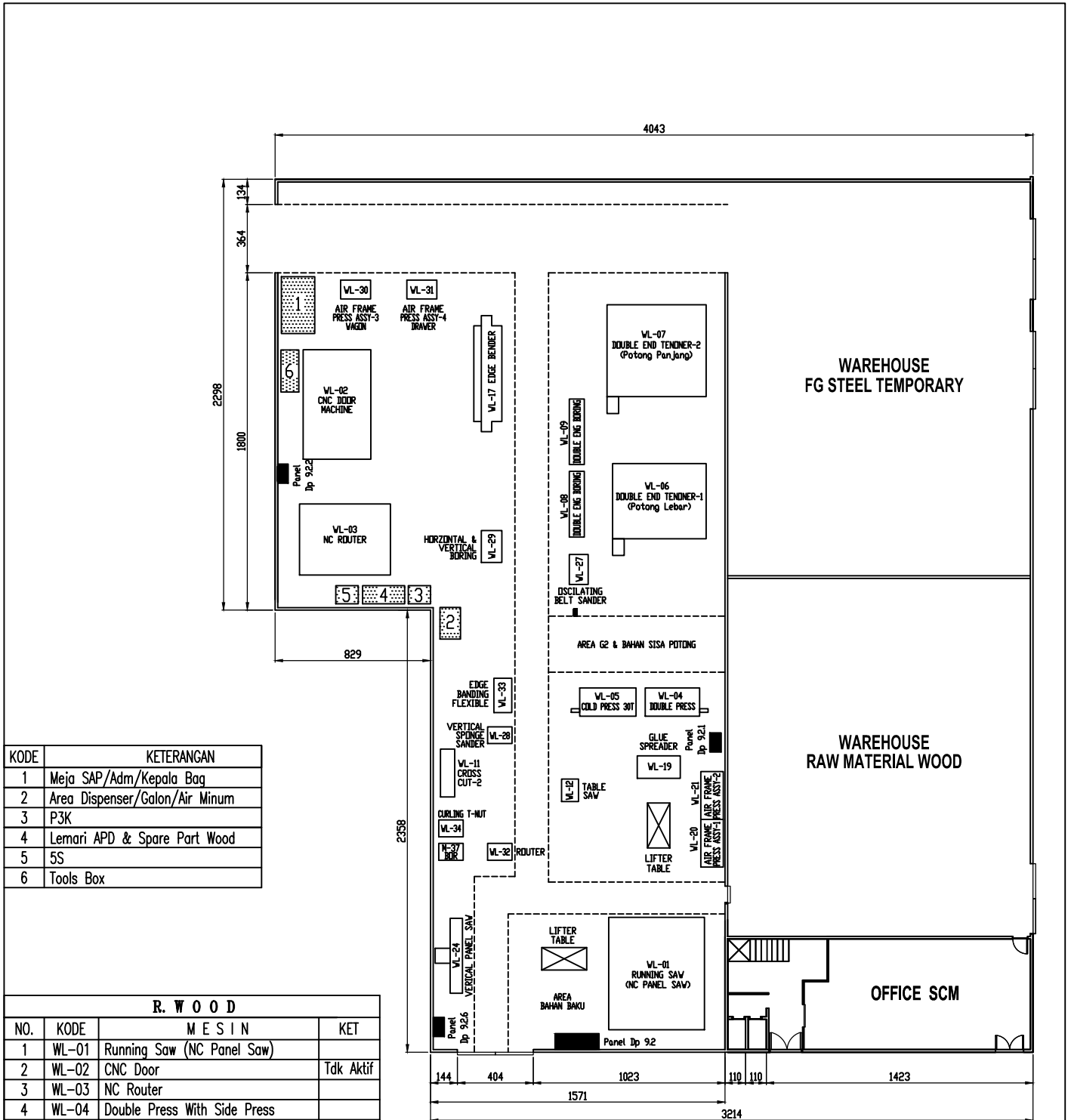

KODE	KETERANGAN
1	Meja SAP/Adm/Kepala Bag
2	Area Dispenser/Galon/Air Minum
3	P3K
4	Lemari APD & Spare Part Wood
5	5S
6	Tools Box

R. WOOD			
NO.	KODE	MESIN	KET
1	WL-01	Running Saw (NC Panel Saw)	
2	WL-02	CNC Door	Tdk Aktif
3	WL-03	NC Router	
4	WL-04	Double Press With Side Press	
5	WL-05	Cold Press 30 Ton	
6	WL-06	Double End Tenoner-1	Tdk Aktif
7	WL-07	Double End Tenoner-2	Tdk Aktif
8	WL-08	Double Eng Boring	
9	WL-09	Double Eng Boring	
10	WL-11	Cross Cut-2	
11	WL-12	Table Saw	
12	WL-17	Auto Edge Bender	
13	WL-19	Glue Spreader 4"	
14	WL-20	Air Frame Press Assembly-1	Tdk Aktif
15	WL-21	Air Frame Press Assembly-2	Tdk Aktif
16	WL-24	Vertical Panel Saw	
17	WL-27	Oscillating Belt Sander	
18	WL-28	Vertical Sponge Sander	
19	WL-29	Horizontal & Vertical Boring-2	
20	WL-30	Air Frame Press Assembly-3 Wagon	
21	WL-31	Air Frame Press Assembly-4 Drawer	
22	WL-32	Router	
23	WL-33	Edge Banding Flexible	
24	WL-34	Press Pneu Curling T-Nut M5	
25	M-37	Bor	

	REVISI	TANGGAL EFEKTIF	NAMA, PARAF, TANGGAL			Gambar : LAYOUT R. WOOD LINE MANUFACTURING SYSTEM DEVELOPMENT PT Chitose Internasional Tbk
	Δ	17.08.2024	DIGAMBAR	DIPERIKSA	DISETUJUI	
	Δ		O. Tedyo			

Schwan : CM
 Sudo : -
 Holoman : -

R. W W T P - 1	
KODE	M E S I N
WT-01	Panel Control System WWTP
WT-02	Doshing Pump-1 (Flocculant)
WT-03	Mixer-1 (Flocculant)
WT-04	Doshing Pump-2 (Sulfide)
WT-05	Mixer-2 (Sulfide)
WT-06	Doshing Pump-3 (NaOH)
WT-07	Mixer-3 (NaOH)
WT-08	Doshing Pump-4 (NaOH)
WT-09	Doshing Pump-5 (H2SO4)-rusak
WT-10	Mixer-4 (Ferro)-tdk aktif
WT-11	Doshing Pump-6 (Ferro)-rusak
WT-12	Mixer-5 (Sulfide Pacipitation)
WT-13	Mixer-6 (Hydroxide Pacipitation)
WT-14	Mixer-7 (Crome Reduction)
WT-15	Motor Pompa (Nickle)
WT-16	Mixer-8 (Flocculation)

R. W W T P - 2	
KODE	M E S I N
LB-01	Pompa Limbah-1
LB-02	Pompa Limbah-2
LB-03	Pompa Tangki Fluculator-1
LB-04	Pompa Tangki Fluculator-2
LB-05	Lift
LB-06	Sludge
LB-09	Pompa Sirkulasi (Oksidasi)
LB-10	Mesin Press Limbah-1
LB-12	Pompa Diafragma-2
D-08	Air Compresor (Meiji)

KODE	KETERANGAN
1	Area Penyimpanan Kimia Limbah Padat
2	Area Penyimpanan Kimia Limbah Cair
3	Tempat Sampah & Alat 5S (Lt.2)
4	Locker Baju Ganti (Lt.2)
5	Meja Staff/ADM (Lt.2)
6	Area Dispenser/Galon/Air Minum (Lt.2)
7	Penyimpanan Sepatu Karet (Lt.2)
8	Tempat Sampah

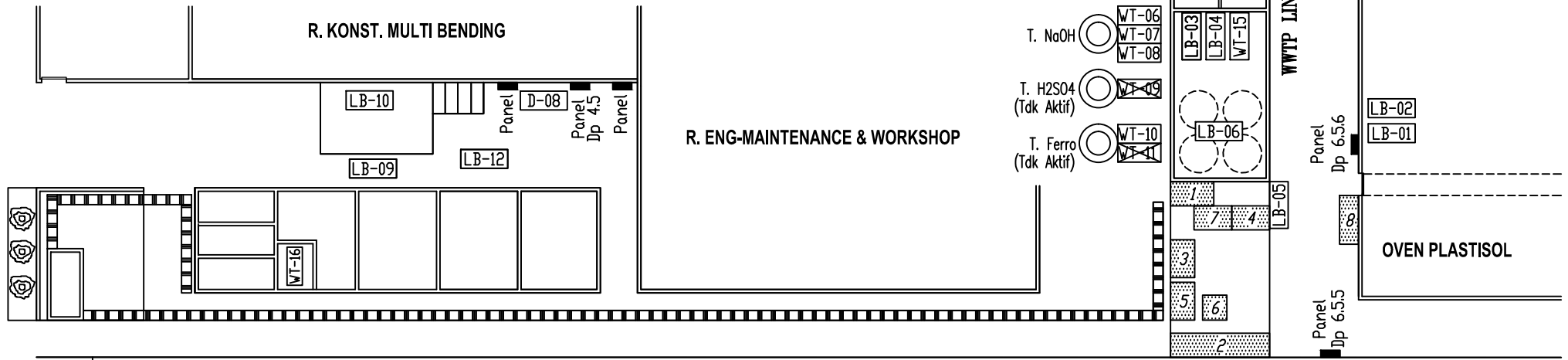

REVISI	TANGGAL EFEKTIF	NAMA, PARAF, TANGGAL			Gambar :
		DICAMBAR	DIPERIKSA	DISETUJUI	
▲	22.11.2024	O. Tahya			L A Y O U T W W T P MANUFACTURING SYSTEM DEVELOPMENT PT Chitose Internasional Tbk
▲					
▲					
▲					

Satuan : CM
 Skala : --
 Halaman : --

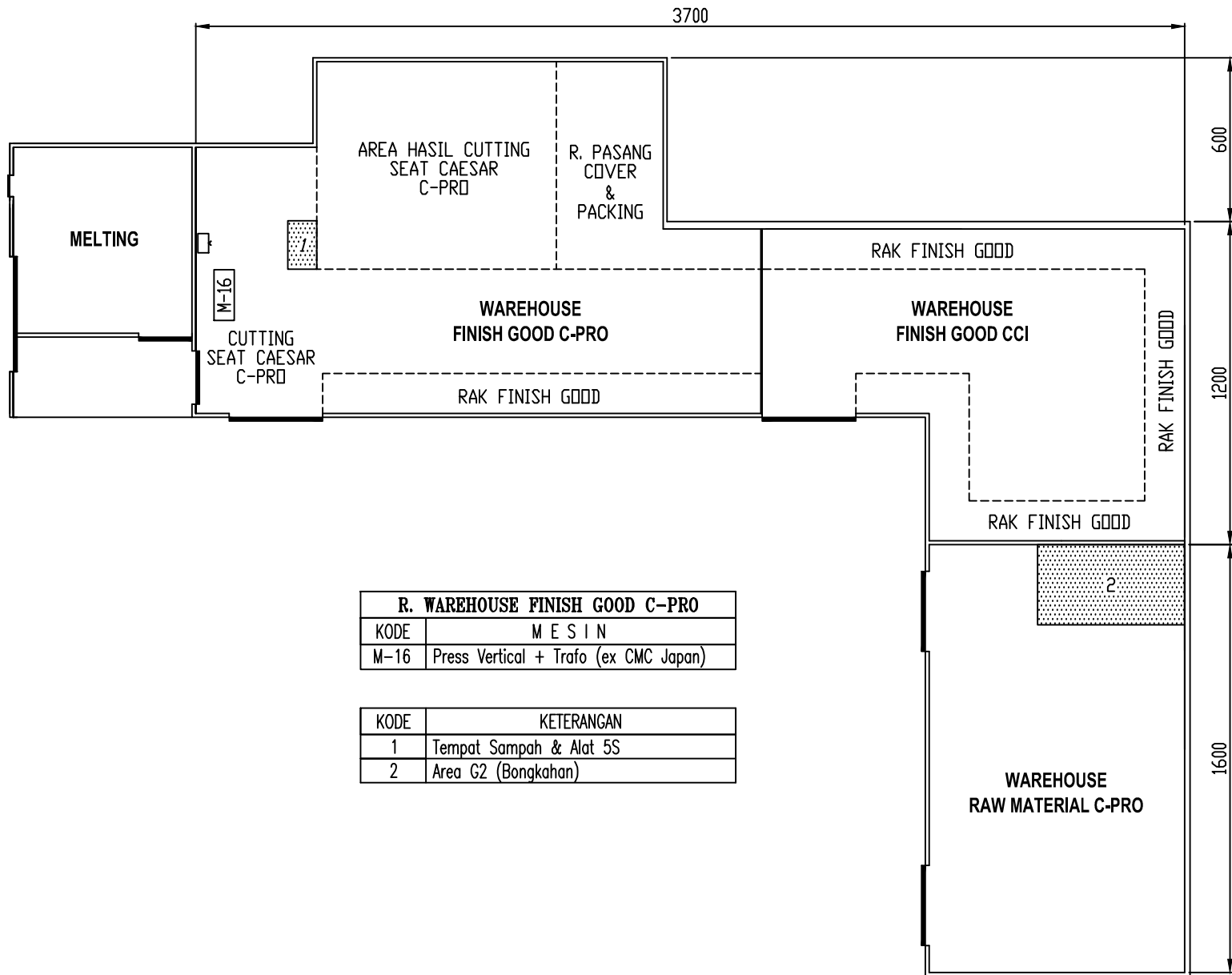

R. WAREHOUSE FINISH GOOD C-PRO	
KODE	M E S I N
M-16	Press Vertical + Trafo (ex CMC Japan)

KODE	KETERANGAN
1	Tempat Sampah & Alat 5S
2	Area G2 (Bongkahan)

U ←	REVISI	TANGGAL	NAMA, PARAF, TANGGAL			Gambar : L A Y O U T R. WAREHOUSE C-PRO MANUFACTURING SYSTEM DEVELOPMENT PT Chitose Internasional Tbk
		EFEKTIF	DIGAMBAR	DIPERIKSA	DISETUJUI	
	△	22.11.2024	O. Tahyo	.	.	
	△					
						Soluan : CM Skala : - Halaman : -

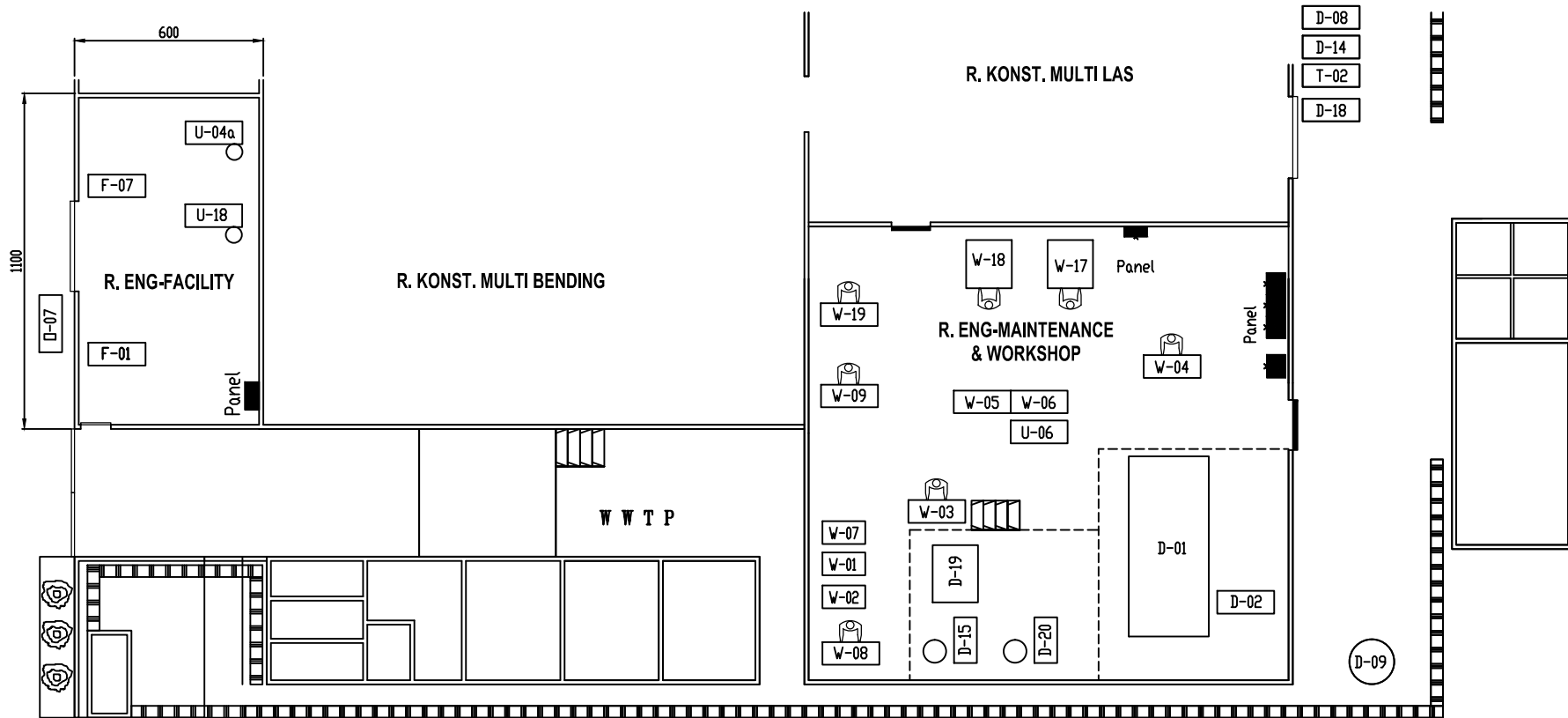

R. WORKSOP	
KODE	MESIN
W-01	Grinder
W-02	Grinder
W-03	Bandsaw
W-04	Bandsaw
W-05	Bor
W-06	Bor
W-07	Grinder Universal
W-08	Grinding
W-09	Bubut Jpn (Howa)
W-17	Milling-4 (Cia Mix)
W-18	Milling-5 (Cia Mix, Jan 2018)
W-19	Bubut (Cia Mix, Peb 2020)
U-06	Auto CO2 Welder

R. FACILITY	
KODE	MESIN
F-01	Bor Machine-1
F-03	Burner & Oven Coating Hanger
F-04	Tanki Plastisol
F-07	Bor Machine-3
O-07	Metabo
U-04a	Auto CO2 Welder
U-18	Auto CO2 Welder

R. MAINTENANCE		
NO.	KODE	MESIN
1	D-01	Generator (SKL)
2	D-02	Air Compressor (Heigh Pressure) - Utk Generator
3	D-09	Cooling Tower (Genset)
4	D-15	Air Dryer-1 Meiji
5	D-18	Metabo
6	D-19	Air Compressor Kobelion II Type VS-75KW
7	D-20	Air Dryer -3 Orion CRX 120 D
8	D-08	Air Compressor-5 Mobile (Meiji 15 Kw)
9	D-14	Air Compressor-9 Mobile (Swan 10 pK)
10	T-02	Air Dryer

	REVISI	TANGGAL EFEKTIF	NAMA, PARAF, TANGGAL			Gambar : L A Y O U T R. ENGINEERING & GAC MANUFACTURING SYSTEM DEVELOPMENT PT Chitose Internasional Tbk
	Δ	22.11.2024	DIGAMBAR	DIPERIKSA	DISETUJUI	
	Δ					
	Δ					

Seluran : CM
 Skala : -
 Halaman : -