

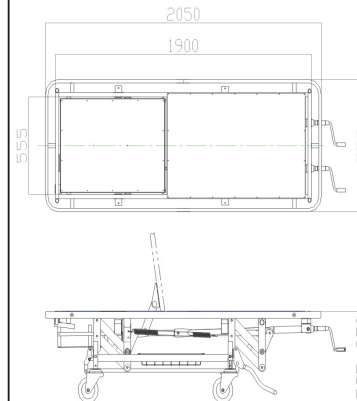

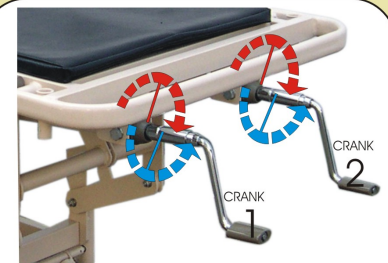



DIMENSION



CRANK OPERATION



CRANK 1		Turn around clockwise to lift up the back bottom.
		Turn around counter clockwise to degrading the back bottom.
CRANK 2		Turn around clockwise to achieve the Bed highest position
		Turn around counter clockwise to achieve the Bed lowest position

- Do not use Stretcher under abnormal condition (Operating system malfunction, broken wheel, etc.)
- At idle condition, make sure the crank on the locked position (Folded into the underside of Stretcher)

Customer Service Contact :

PT Chitose Indonesia Mfg

Jl. Industri III No. 5 Leuwigajah

Cimahi 40533 - INDONESIA

Phone : (022) 603 1900

Fax : (022) 603 1855

e-mail : aan@chitose-indonesia.com

Chitose[®]

Innovation by your Inspiration

OXYGEN BOX CONTAINER

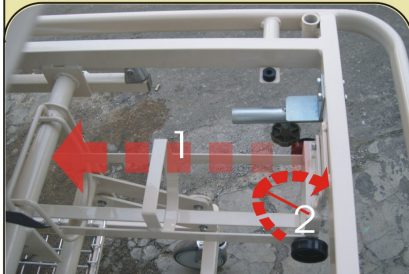

1. Put the oxygen box at the container
2. Lock the container

TOTAL LOCK

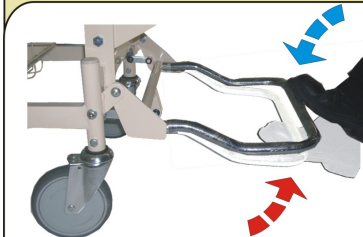

- Step on the wheel lever to lock the wheel.
- Lift up the wheel lever to release.

IRRIGATOR BAR BRACKET

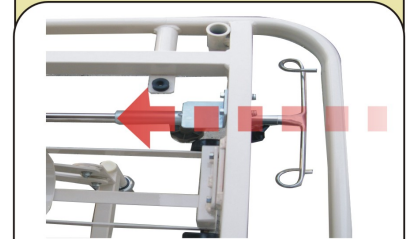

Put the Irrigator Bar on the bracket (at frame head side) if not being used.

FOLDING SIDERAIL

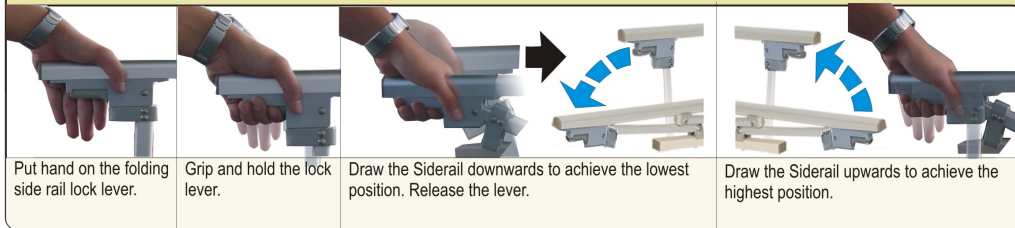

Put hand on the folding side rail lock lever.

Grip and hold the lock lever.

Draw the Siderail downwards to achieve the lowest position. Release the lever.

Draw the Siderail upwards to achieve the highest position.

Customer Service Contact :
PT Chitose Indonesia Mfg
Jl. Industri III No. 5 Leuwigajah
Cimahi 40533 - INDONESIA
Phone : (022) 603 1900
Fax : (022) 603 1855
e-mail : aan@chitose-indonesia.com